

# BOX 100

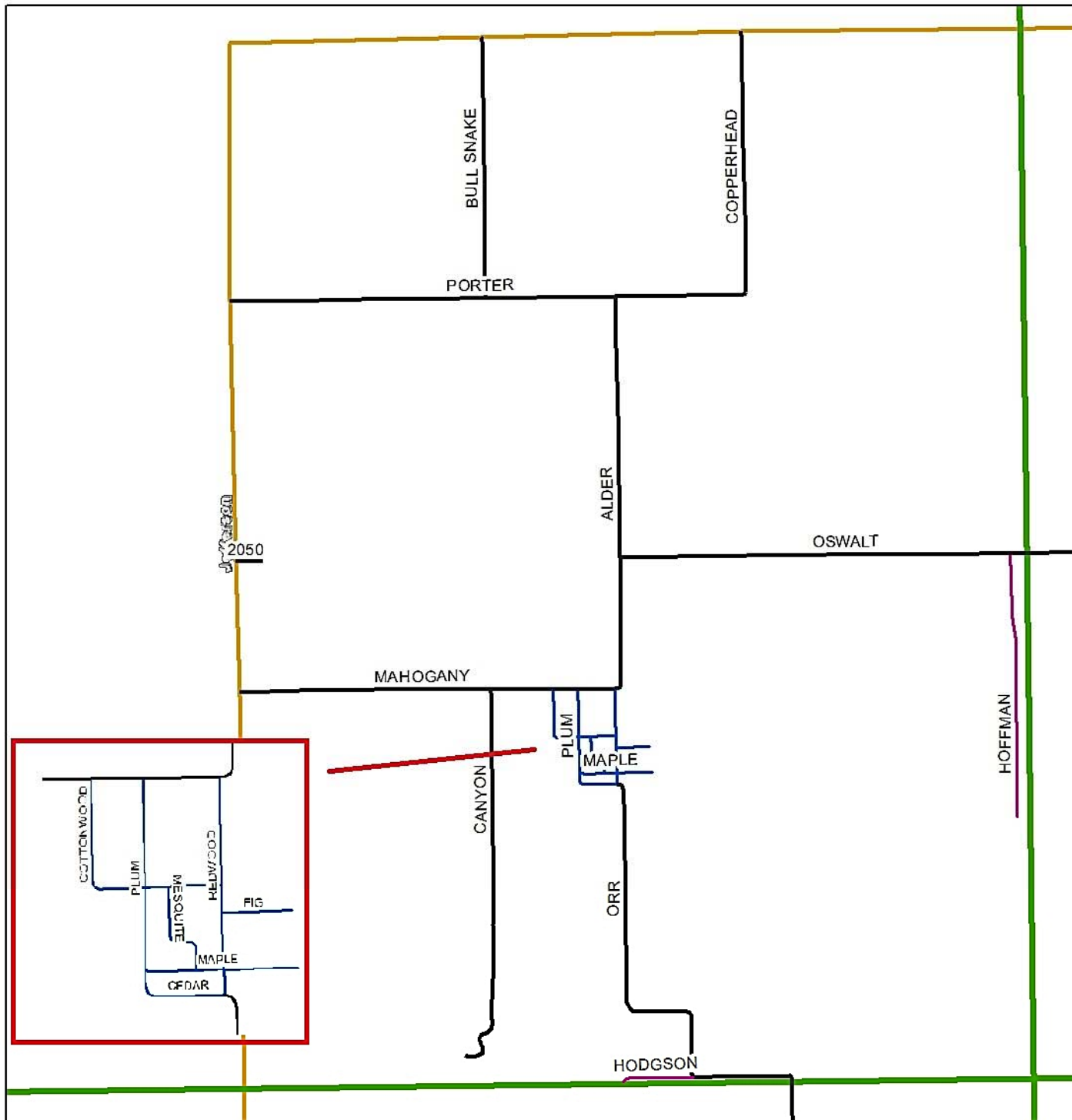

- ALDER
- BULL SNAKE
- CANYON
- CEDAR
- COPPERHEAD
- COTTONWOOD
- E 2050
- FIG
- HODGSON
- HOFFMAN
- MAHOGANY
- MAPLE
- MESQUITE
- ORR 2500-3697
- OSWALT 33126-34499
- PLUM
- PORTER
- ROBERTS

# BOX 102

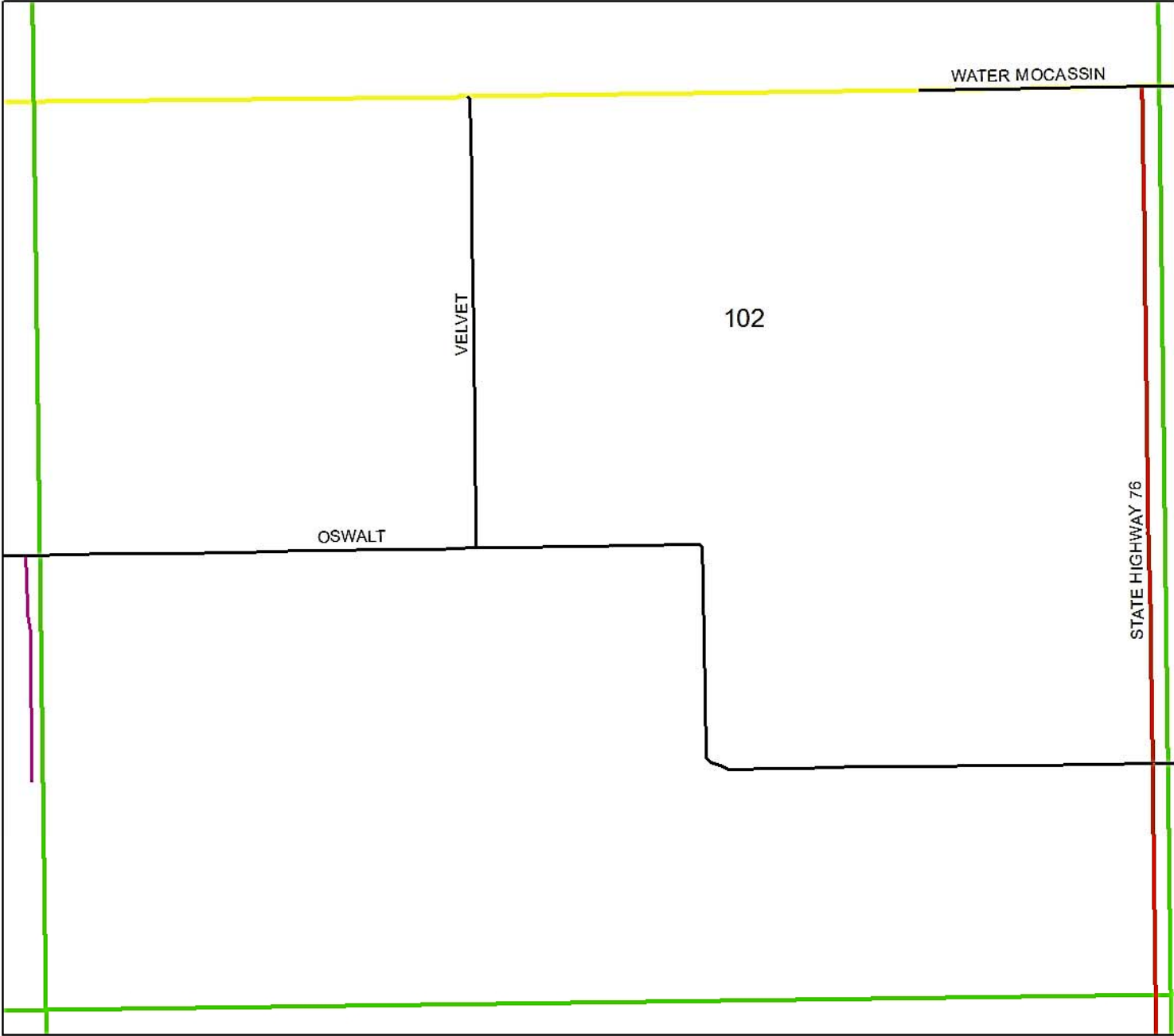

- BOX 102 STREETS
- OSWALT RD 28000-33125
- S STATE HIGHWAY 76  
1-29999
- VELVET RD
- WATER MOCCASIN RD 3000-4009

# BOX 103

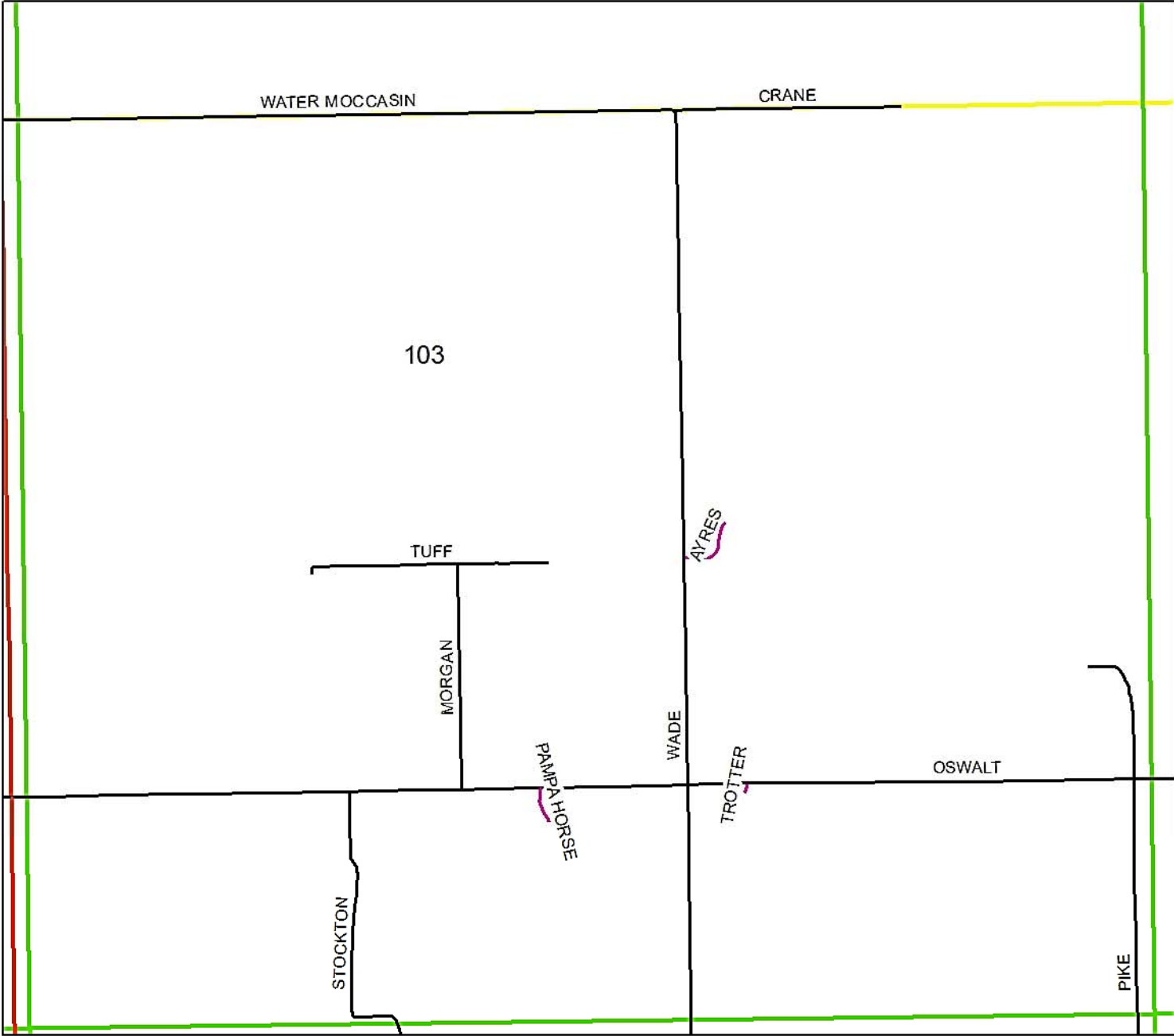

- BOX 103 STREETS
- AYRES LN
  - CRANE RD
  - MORGAN RD
  - OSWALT RD 23000-27999
  - PAMPA HORSE LN
  - PIKE RD 2500-3999
  - STOCKTON RD 3000-37843
  - TROTTER LN
  - TUFF ST
  - WADE RD 1-3999
  - WATER MOCCASIN RD 24-2999

# BOX 104

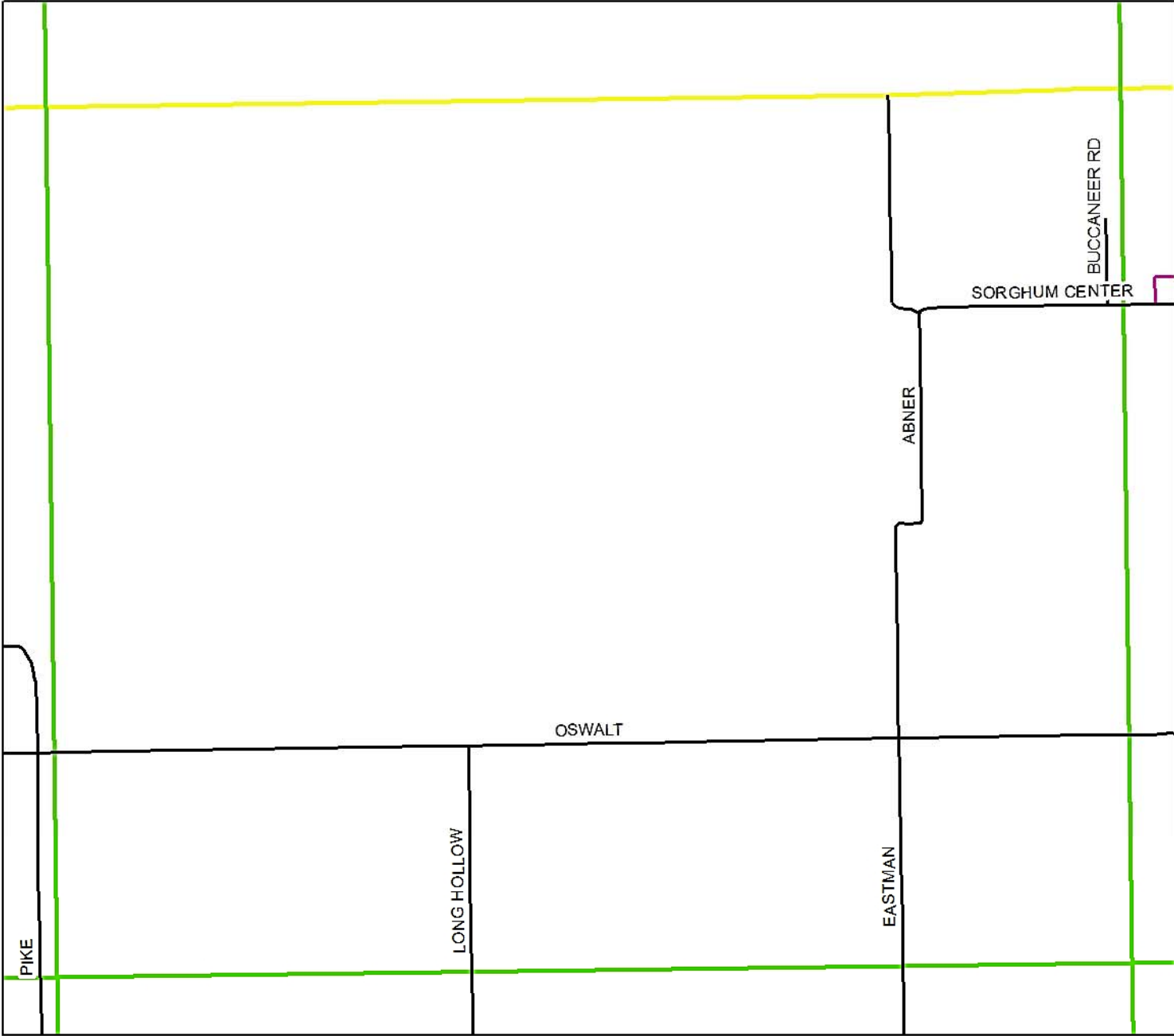

## BOX 104 STREETS

- ABNER RD
- BUCCANEER RD
- EASTMAN RD 3000-3871
- LONG HOLLOW RD 3000-3999
- OSWALT RD 17952-22999
- SORGHUM CENTER RD  
17922-18999

# BOX 105

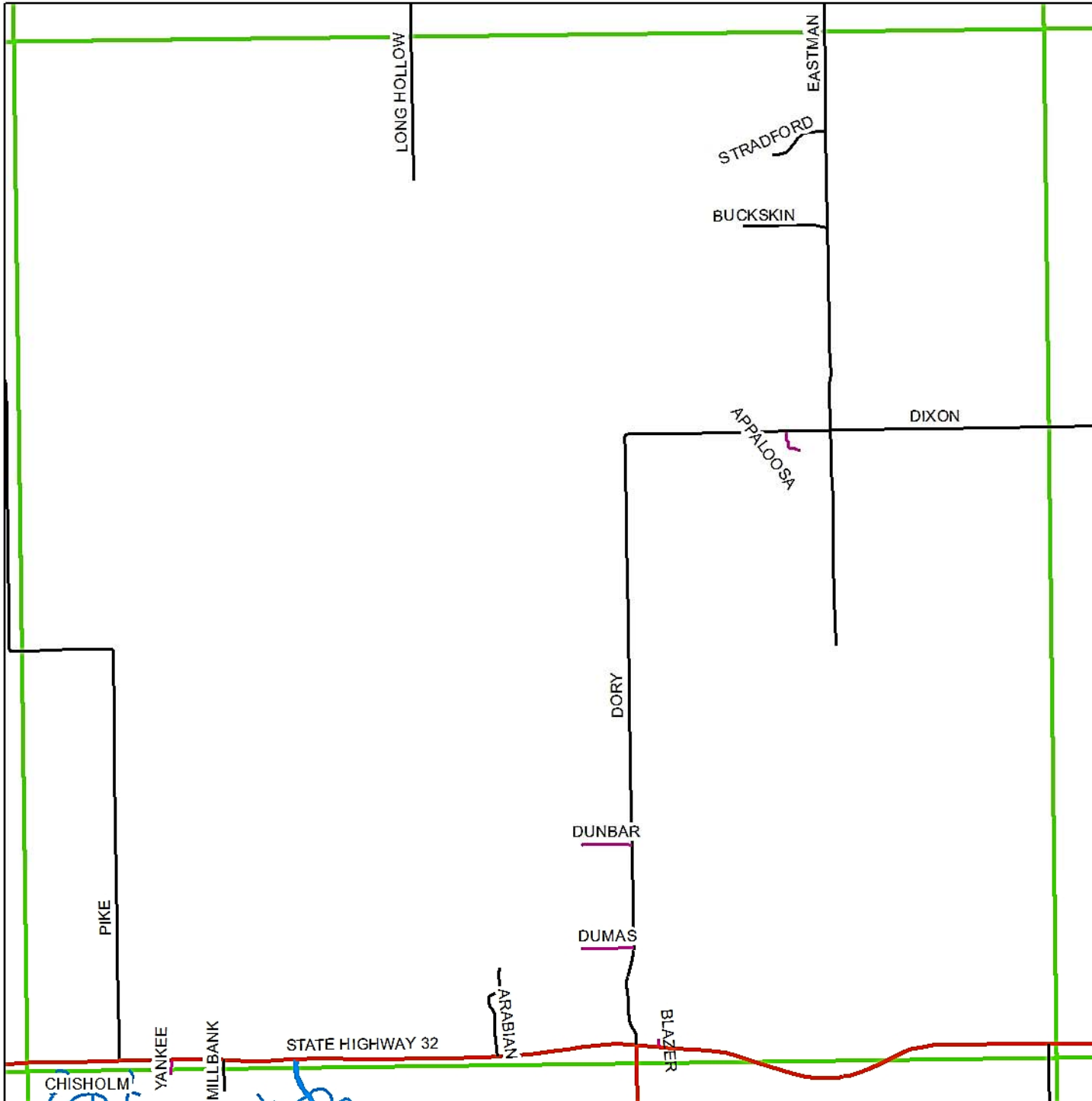

## BOX 105 STREETS

APPALOOSA LN

ARABIAN RD

BLAZER LN

BUCKSKIN DR

DIXON RD 17940-19999

DORY RD

DUMAS LN

DUNBAR LN

EASTMAN RD 3872-7055

LONG HOLLOW RD 4000-4758

MILLBANK RD

PIKE RD 6796-8999

STATE HIGHWAY 32  
18000-22939

STRADFORD RD

YANKEE LN



# BOX 107



## BOX 107 STREETS

BUSH LN

EISENHOWER LN

FURRH RD

HULL RD 27000-27999

KENNEDY RD

NIXON LN

ORR RD 6082-8999

RODEO RD

RUBOTTOM RD

S STATE HIGHWAY 76  
4000-8999

STATE HIGHWAY 32  
28000-32999







# BOX 110

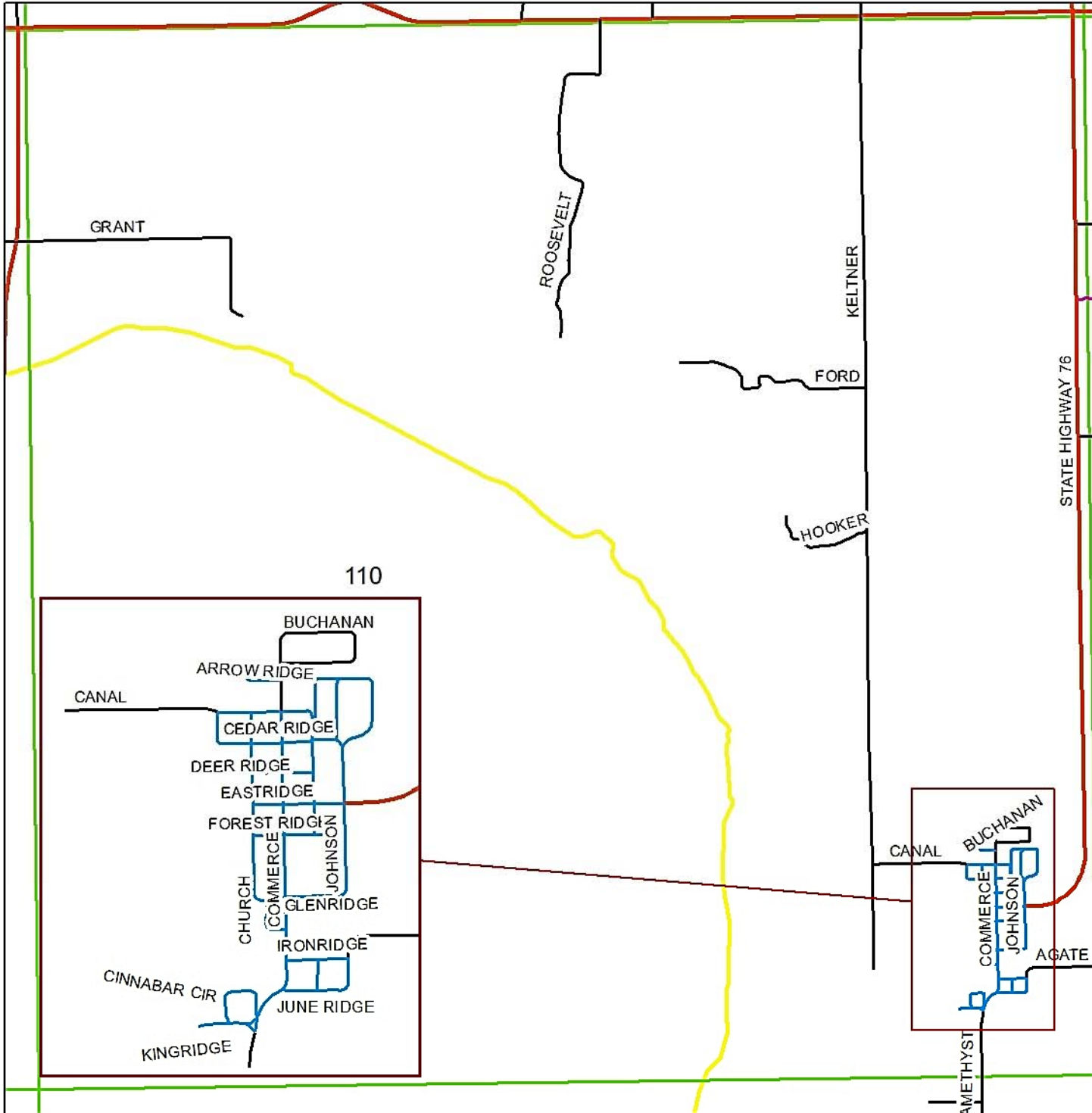
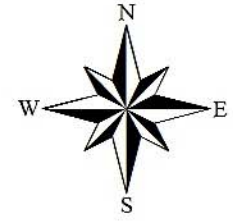

## BOX 110 STREETS

- AGATE RD 27934-28163
- AMETHYST ST 13710-14015
- ARROWRIDGE ST
- BLUE RIDGE ST
- BUCHANAN CIR
- CANAL RD
- CEDAR RIDGE ST
- CHURCH ST
- CINNABAR CIR
- COLLEGE ST
- COMMERCE ST
- DEER RIDGE ST
- EASTRIDGE ST
- FORD RD
- FOREST RIDGE ST
- GLENRIDGE ST
- GRANT RD 31938-33027
- HOOKER RD
- IRONRIDGE ST
- JEFFERSON RD
- JOHNSON ST
- JUNERIDGE ST
- KELTNER RD
- LEON CEMETARY CIR
- ROOSEVELT RD
- STATE HIGHWAY 76  
9000-13221

# BOX 111

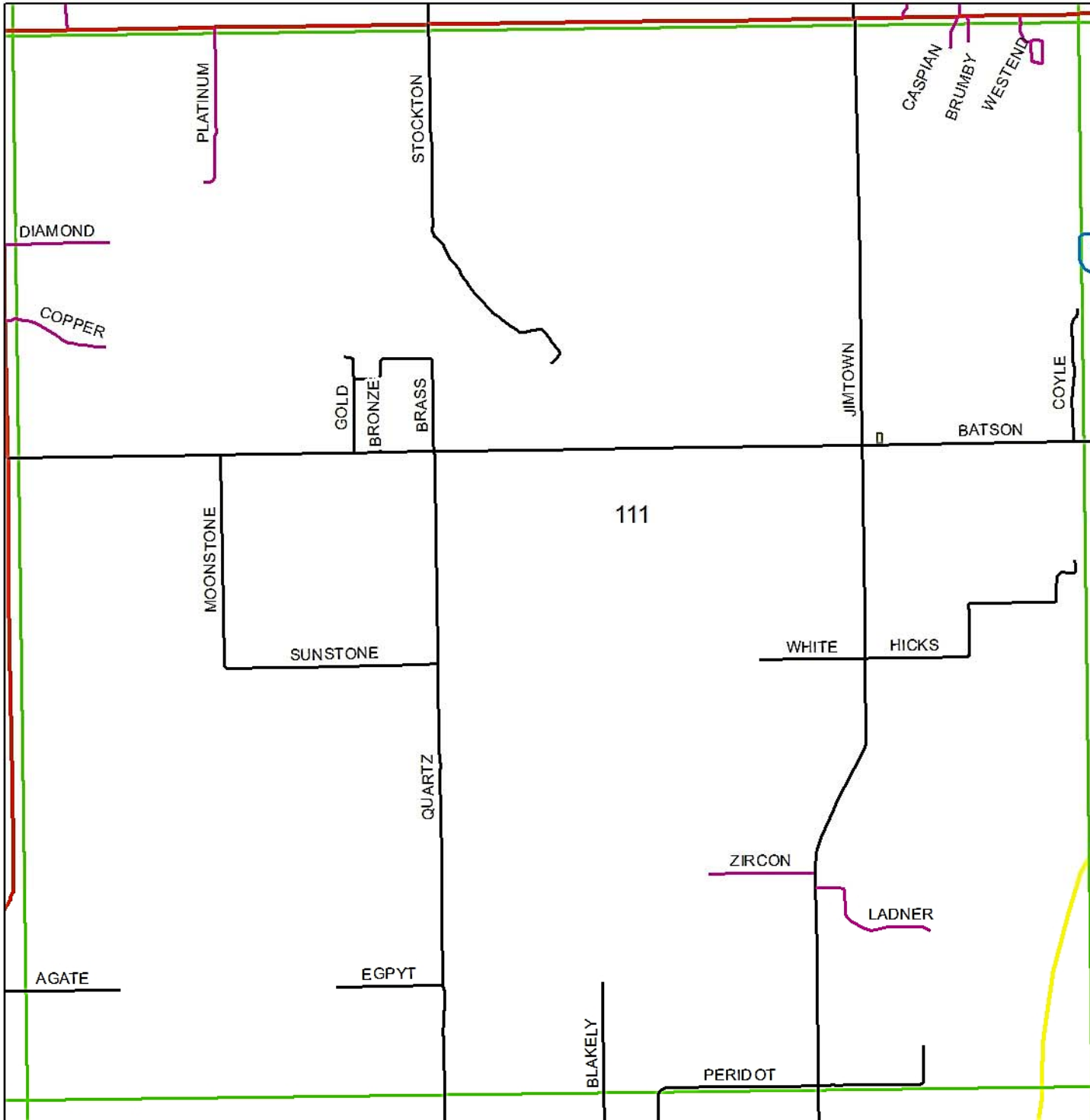
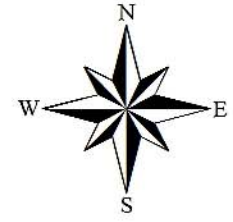

## BOX 111 STREETS

- AGATE RD 27500-27933
- BATSON RD 23000-27999
- BLAKELY RD 135-13787
- BRASS RD
- BRONZE RD
- BRUMBY LN
- CASPIAN LN
- COPPER LN
- COYLE DR
- DIAMOND LN
- EGPYT RD
- GOLD RD
- HICKS RD
- JIMTOWN RD 9000-13999
- LADNER LN
- MOONSTONE RD
- PERIDOT RD 23576-24950
- PLATINUM LN
- QUARTZ RD 11000-14003
- STOCKTON RD 9000-9973
- SUNSTONE RD
- WESTEND DR
- WHITE RD
- ZIRCON LN

BOX 112 STREETS

BOX 112

\*ABERDEEN DR  
 \*ALTUS PL  
 \*ANADARKO DR  
 \*APACHE PL  
 \*ARROWHEAD DR  
 \*ASH PL  
 \*ASHLEY GARDENS DR  
 \*ASPEN PL  
 \*BALMERINO PL  
 \*BANKSIDE DR  
 BATSON RD 22178-22999  
 \*BEAVER DR  
 \*BIRCH PL  
 \*BLACKHALL DR  
 \*BLAIR PL  
 BLUFF RD  
 \*BOISE DR  
 \*BONNELL PL  
 \*BONNY BANK DR  
 \*BRADY DR  
 \*BRAZOS PL  
 BRUG HARTMAN RD  
 \*BUFFALO PL  
 BURNEY RD  
 BURNEYVILLE RD  
 \*CACTUS DR  
 \*CALLANDER DR  
 \*CALVARY DR  
 \*CANADIAN DR  
 \*CARTER PL  
 \*CHANDLER CT  
 \*CHICKASHA CIR  
 \*CHISHOLM TRL  
 \*CIMARRON CIR  
 \*COLGATE CT  
 \*COMANCHE DR  
 \*CONWAY PL  
 \*CORDELL CIR  
 \*CULP DR

\*CUSTER DR  
 \*CUTOFF PASS  
 \*CYPRESS AVE  
 \*DARRELL DR  
 DENTON DR  
 \*DEWEY DR  
 \*DIAMOND PL  
 \*DIAMONDHEAD PL  
 \*DIAMONDHEAD DR  
 \*DOGWOOD DR  
 \*DRAKE DR  
 \*DUNCAN DR  
 \*DUNVERNY DR  
 \*DURANT DR  
 E&W PONDEROSA PL  
 \*ELM PL  
 \*ENID PL  
 \*EUFAULA PL  
 \*FAIRWAY DR  
 FALCON DR  
 \*FALCONHEAD CIR  
 \*FALCONHEAD DR  
 \*FALCONHEAD ACCESS RD  
 \*FRANKS PL  
 \*FRONTIER DR  
 \*GARVIN PL  
 \*GAYE PL  
 \*GLENDEVON DR  
 \*GLENTURRET DR  
 \*GOLF CLUB DR  
 \*GRAND WALL  
 \*GREENBRIAR AVE  
 GUNSMOKE RD  
 \*GUYMON PL  
 \*HAMM PL  
 \*HAYWICK DR  
 \*HAYWICK PL  
 \*HICKORY PL  
 \*HOBART PL  
 \*HOLIDAY DR

\*HOLLIS PL  
 \*HUNTLY DR  
 \*IDABEL PL  
 INDIAN MERIDIAN RD  
 \*IVERNESS DR  
 \*JEANNE PL  
 \*JESSEE PL  
 \*JOYE PL  
 \*JUNIPER PL  
 \*KENNOWAY LOOP  
 \*KIAMICHI PL  
 \*LAKEVIEW DR  
 \*LAMAR LN  
 \*LARAMIE DR  
 LARIAT LN  
 \*LAWTON LN  
 \*LEON LN  
 \*LILAC PL  
 \*LOCHSIDE DR  
 \*LOGAN LN  
 LOONEY DR  
 \*LOUISE DR  
 \*MADILL WAY  
 \*MAGNOLIA AVE  
 \*MARGARET RD  
 \*MARIETTA CIR  
 \*MARTIN DR  
 \*MARY ANNE DR  
 \*MASTERS DR  
 MAVERICK DR  
 \*MCCLAIN PL \*MCCLURE CIR  
 \*MCKINNEY CIR  
 \*MILBURN DR  
 \*MIMAI PL  
 \*MURRAY PL  
 \*MUSKOGEE DR  
 \*NECHES PL  
 \*NEOSHO PL  
 NOBLE FDN RD  
 \*NOWATA PL  
 \*OKEMAH PL

\*OKMULGEE CIR  
 \*PATTON PL  
 \*PAWHUSKA PL  
 \*PEBBLE BEACH DR  
 \*PECOS PL  
 \*PERRY PL  
 \*PIEDMONT PL  
 \*PIONEER PL  
 \*PLATTE PL  
 \*PONCA DR  
 \*POPLAR PL  
 \*POTEAU DR  
 \*PRAIRIE PL  
 \*PRESTON PL  
 \*PRYOR PL  
 \*QUANAHA DR  
 RAINFORD LN  
 RAVEN RD  
 \*RED RIVER AVE  
 RED RIVER RANCH DR  
 \*RED ROCK RD  
 \*REDBUD LN  
 REDHAWK RD  
 \*RHONDA CIR  
 \*RIO RD  
 \*RYAN RD  
 \*SABINE PL  
 \*SALINA PL  
 \*SALISAW PL  
 \*SANTAFE DR  
 \*SAPULPA DR  
 \*SHADYBROOK RD  
 SHANKLES RD  
 \*SIMPSON PL  
 SPARROW RD  
 STATE HIGHWAY 96  
 \*STEPHENS DR  
 \*SULPHUR DR  
 \*SYCAMORE AVE  
 \*TALGOA PL  
 \*TAYLOR DR  
 TOMBSTONE RD

\*TRINITY PL  
 \*TULSA DR  
 \*TURNER CIR  
 \*TUSCON PL  
 \*VACATION DR  
 \*VALLEY VIEW DR  
 \*VICKIE PL  
 \*VINTA PL  
 \*WACO PL  
 \*WAGONER WAY  
 \*WALTERS WAY  
 \*WASHITA WAY  
 \*WATONGA WAY  
 \*WAURIKA DR  
 \*WAYNE DR  
 \*WENDYL WAY  
 \*WEWOKA DR  
 \*WHITE OAK PL  
 WINCHESTER DR  
 \*YUKON DR

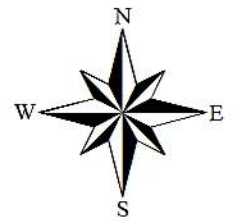

# BOX 112

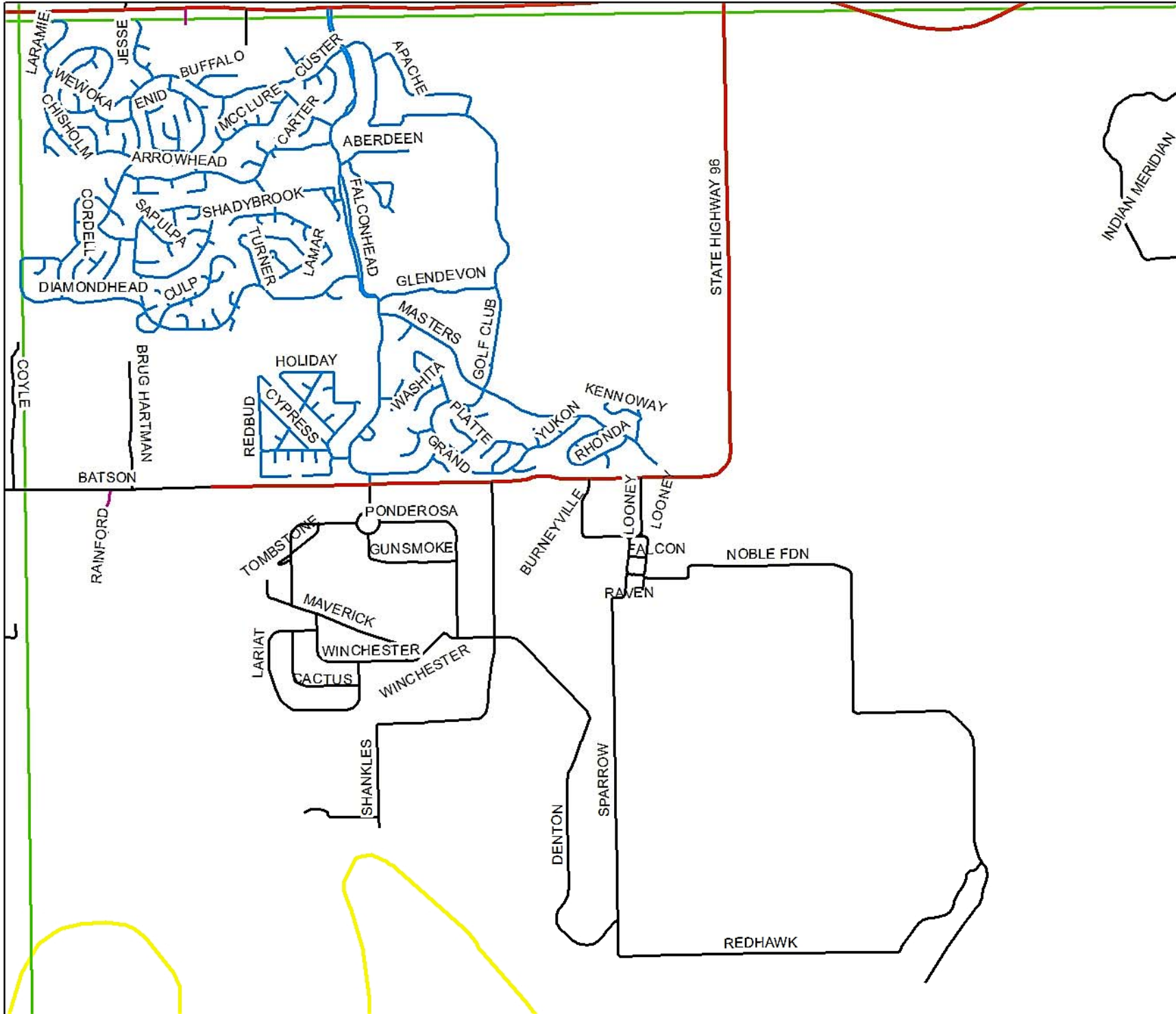

# BOX 113

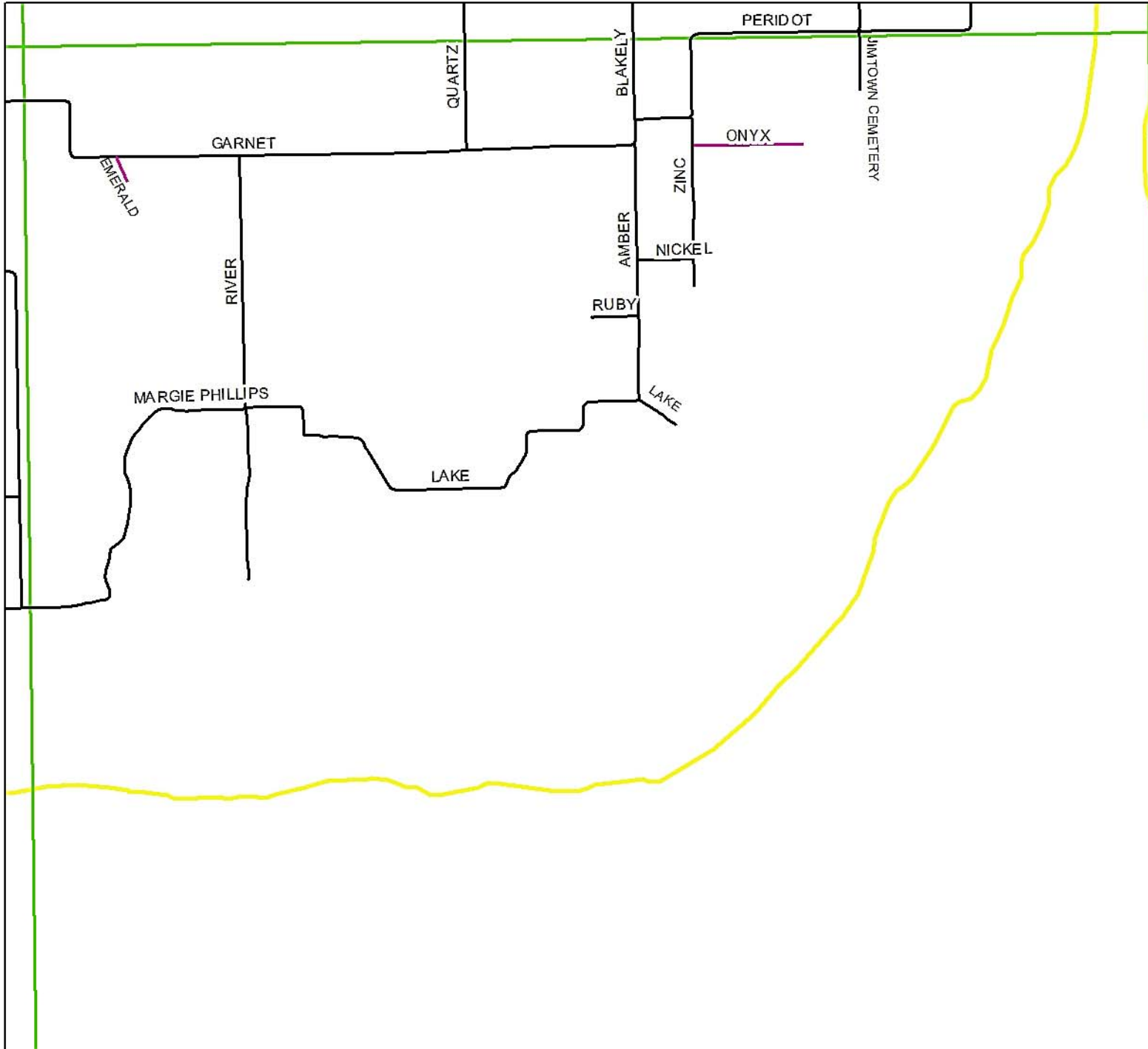

- BOX 113 STREETS
- BLAKELY RD  
13788-13999
  - EMERALD LN
  - GARNET RD  
25000-28019
  - JIMTOWN CEMETERY RD
  - LAKE RD
  - MARGIE PHILLIPS RD  
27000-27999
  - NICKEL RD
  - QUARTZ RD  
14004-14499
  - RIVER RD

# BOX 114

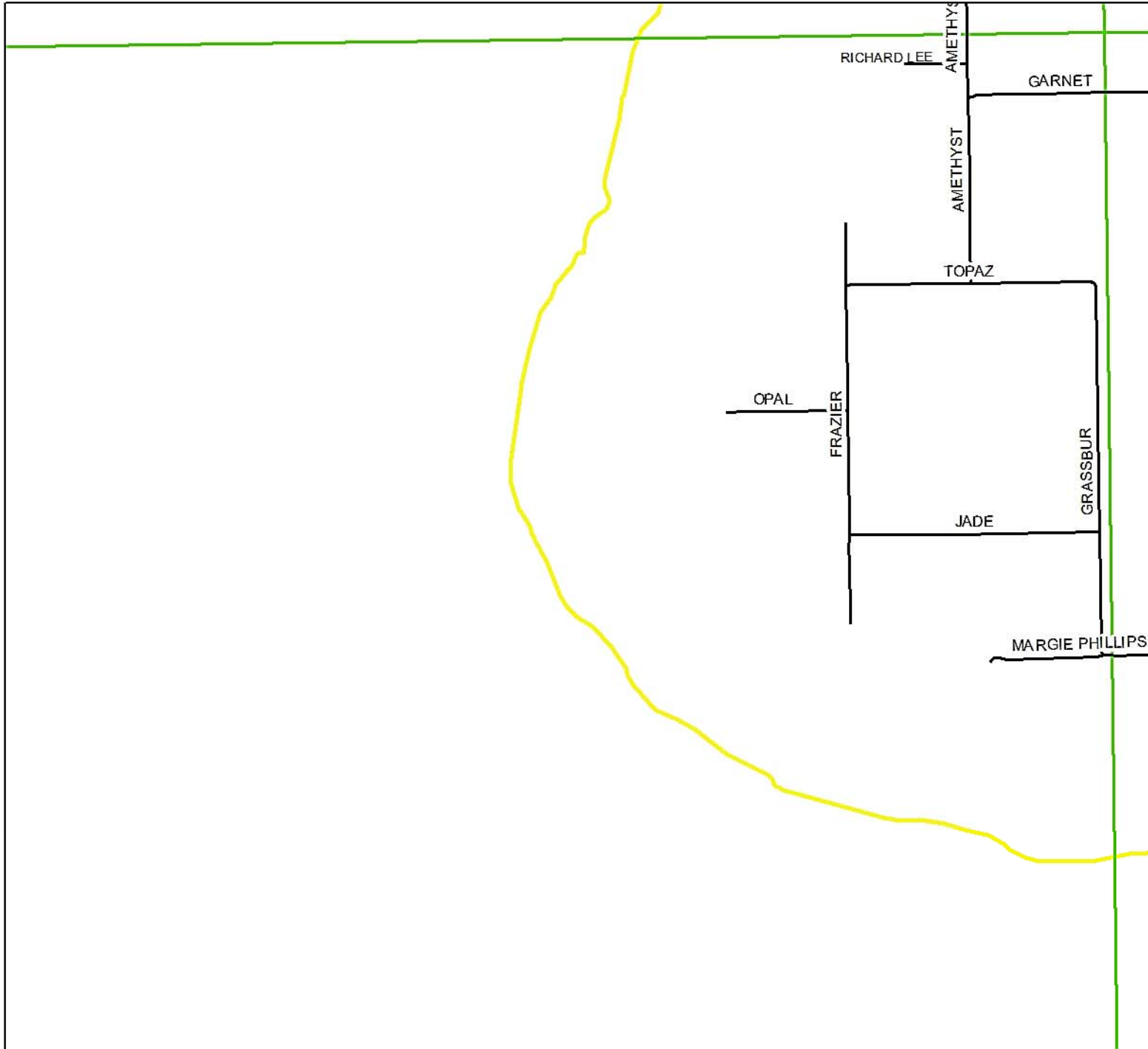

- BOX 114 STREETS
- AMETHYST ST  
14016-14999
  - FRAZIER RD
  - GARNET RD  
28020-28499
  - GRASSBUR RD
  - JADE RD
  - MARGIE PHILLIPS RD  
28000-28499
  - OPAL RD
  - RICHARD LEE RD
  - TOPAZ RD

# BOX 200

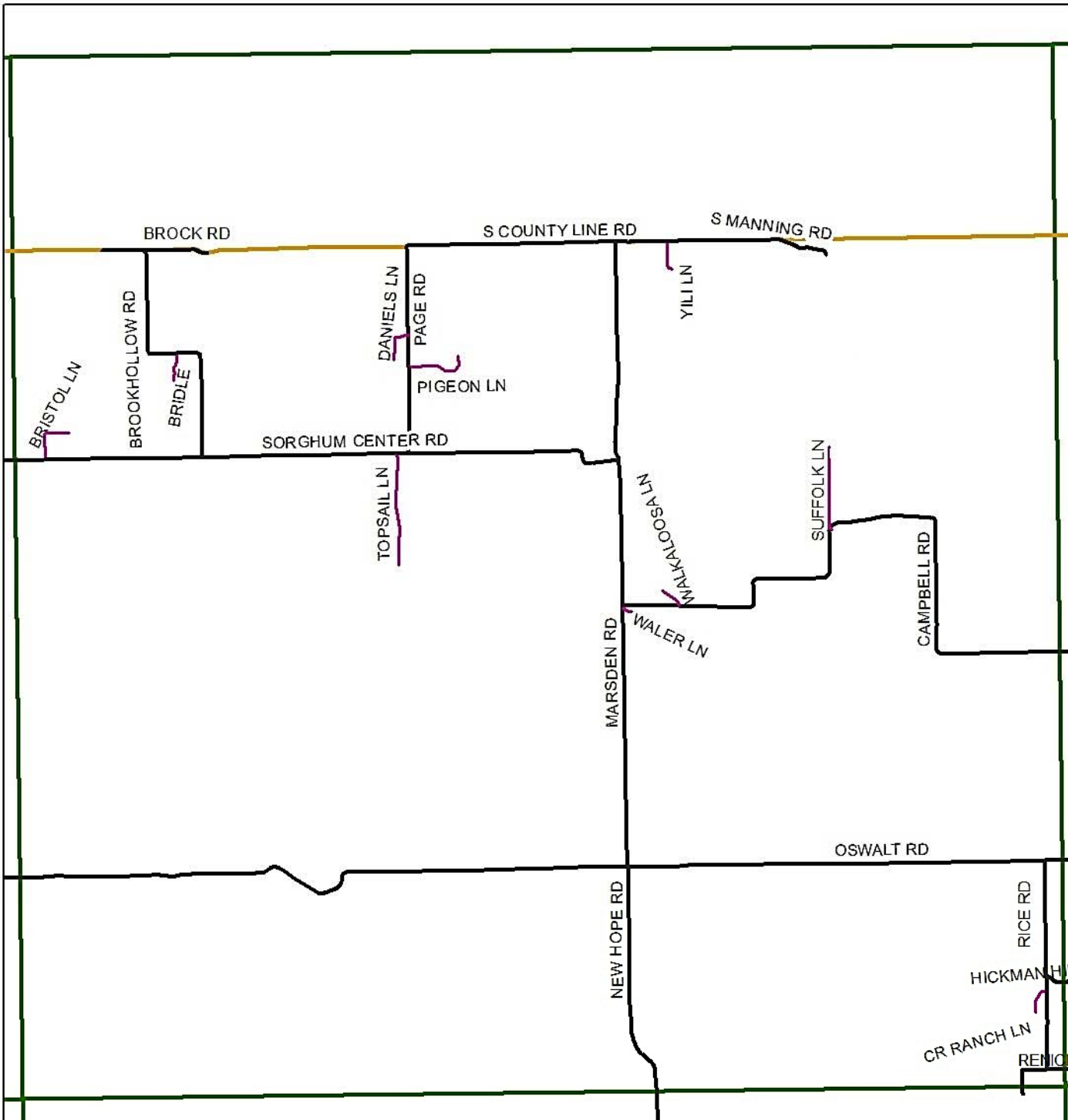

## BOX 200 STREETS

- BRIDLE LN
- BRISTOL LN
- BROCK LN
- CAMPBELL RD 12838-14999
- CR RANCH LN
- DANIELS LN
- HICKMAN HL 12896-12999
- NEW HOPE RD 3000-3849
- OSWALT RD 12912-17957
- PAGE RD
- PIGEON LN
- RENICK RD 12910-13120
- RICE RD
- S COUNTY LINE RD
- S MANNING RD
- SORGHUM CENTER RD  
15000-17925
- SUFFOLK LN
- THOURGHBRED RD
- TOPSAIL LN
- WALER LN
- WALKALOOSA LN
- YILI LN



# BOX 201

## BOX 201 STREETS

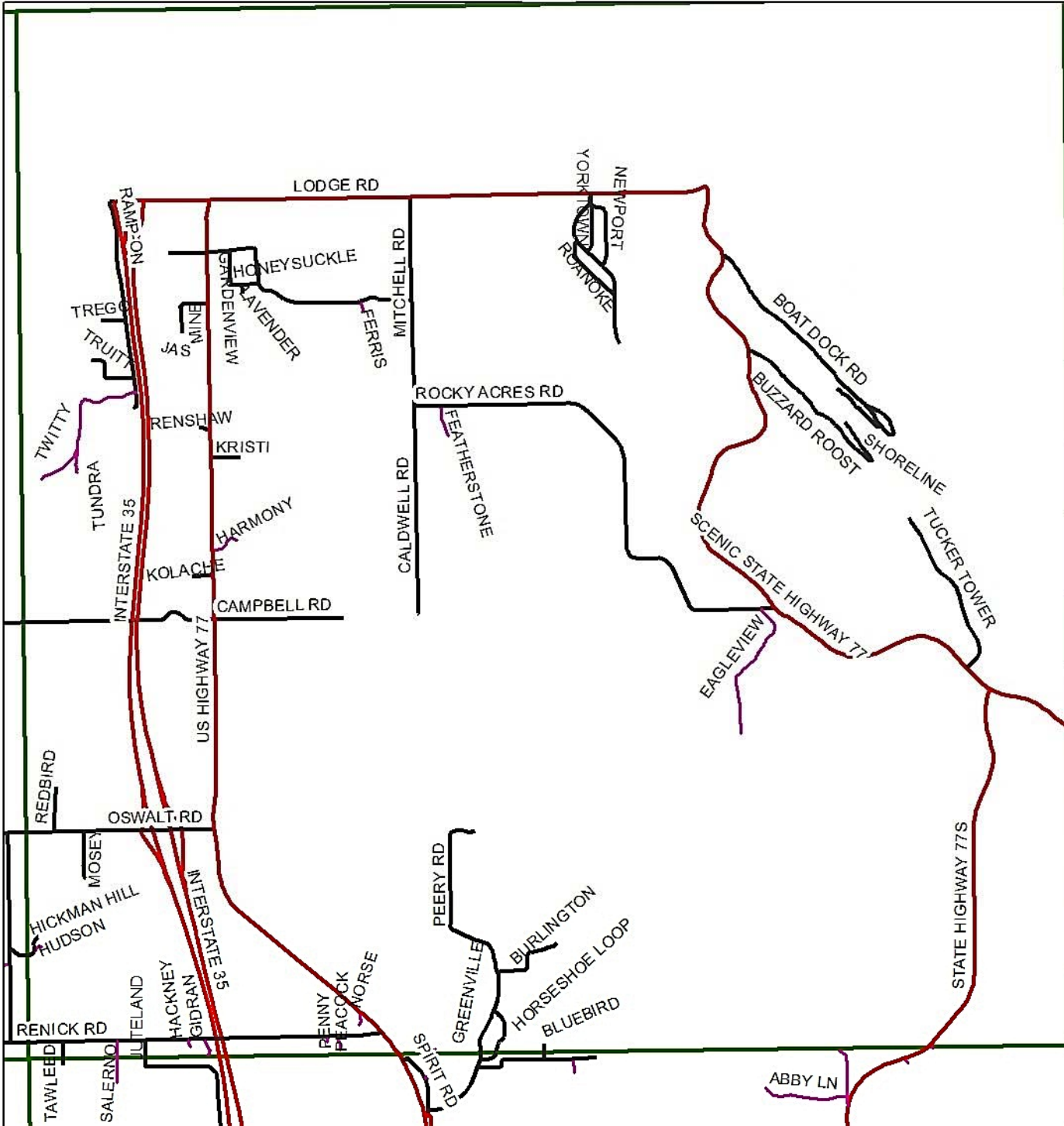

- BLUEBIRD
- BOAT DOCK RD
- BURLINGTON RD
- BUZZARD ROOST
- CALDWELL RD
- CAMPBELL RD 11260-12835
- EAGLEVIEW LN
- EVANS RD
- FEATHERSTONE LN
- FERRIS LN
- GARDENVIEW ST
- GIDRAN LN
- GREENVILLE RD
- HACKNEY RD
- HAMPTON RD
- HARMONY LN
- HICKMAN HILL RD 12764-12895
- HONEYSUCKLE ST
- HORSESHOE LOOP
- JASMINE RD
- JUTELAND RD 4000-4057
- KOLACHE RD
- KRISTI LN
- LAVENDER ST
- LODGE RD 1-2747 (S SIDE)
- MITCHELL RD
- MOSEY RD
- NORSE LN
- OSWALT RD 12000-12911
- OVERBROOK RD
- PEACOCK LN
- PEERY RD
- PENNY LN
- REDBIRD RD
- RENICK RD 11478-12909
- RENSHAW RD
- ROANOKE RD
- ROCKY ACRES
- SALERNO LN
- SCENIC STATE HIGHWAY 77 9927-13190
- SHORELINE RD
- STATE HIGHWAY 77S 2400-4073
- TALWEED RD
- TREGO RD
- TREVOR RD
- TRUITT RD
- TUCKER TOWER
- TUNDRA LN
- TWITTY LN
- US HIGHWAY 77 1-4337
- YORKTOWN RD

# BOX 202

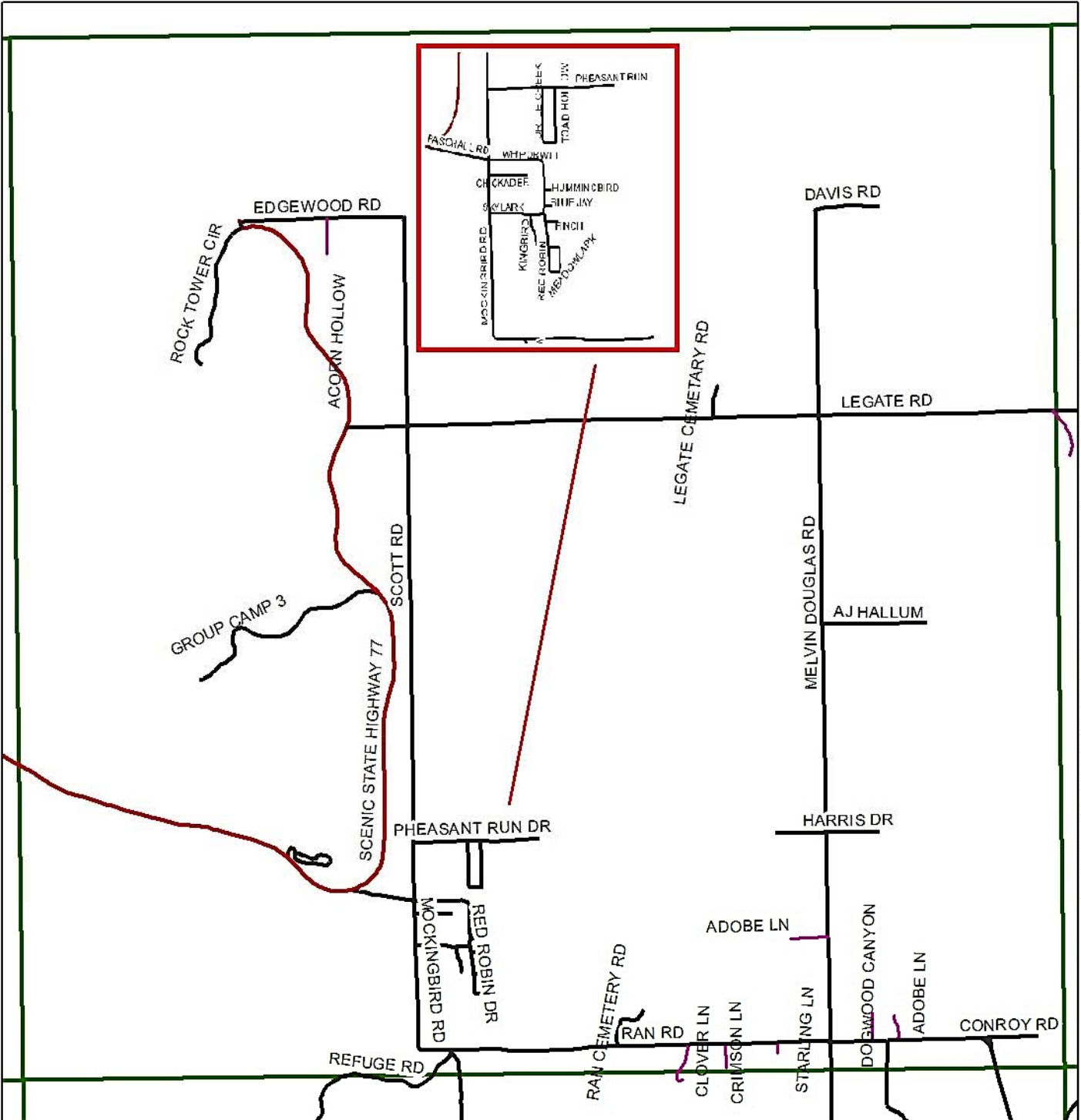

## BOX 202 STREETS

- ACORN HOLLOW LN
- ADOBE LN
- AJ HALLUM RD
- BLUEJAY LN
- CHICKADEE RD
- CLOVER LN
- CHRIMSON LN
- CONROY RD
- DAVIS RD
- DOGWOOD CANYON LN
- EDGEWOOD RD
- FINCH RD
- GROUP CAMP 3
- HARRIS RD
- HUMMINGBIRD LN
- KINGBIRD RD
- LEGATE RD 2892-6299
- MARIETTA LANDING
- MEADOWLARK RD
- MELVIN DOUGLAS RD
- MOCKINBIRD RD
- ORIOLE LN
- PASCHALL RD
- PHEASANT RUN
- RAN RD
- RAN CEMETERY RD
- RED ROBIN RD
- ROADRUNNER RD
- ROCK TOWER
- SCENIC STATE HIGHWAY 77  
4032-9479
- SCOTT RD
- SKYLARK RD
- STARLING LN
- TOAD HOLLOW
- TURTLE CREEK
- WHIPORWILL RD

# BOX 203



203

MARLOVE

LEGATE

SIDEWINDER

VINSON

SLOAN

PARROT

TWO BIRDS

LEGATE RD 2000-2891  
MARLOVE RD  
PARROT LN  
S PICKENS RD (CARTER CO)  
SIDEWINDER LN  
SLOAN RD  
TWO BIRDS 2551-2676  
VINSON RD 3903-4102



# BOX 205

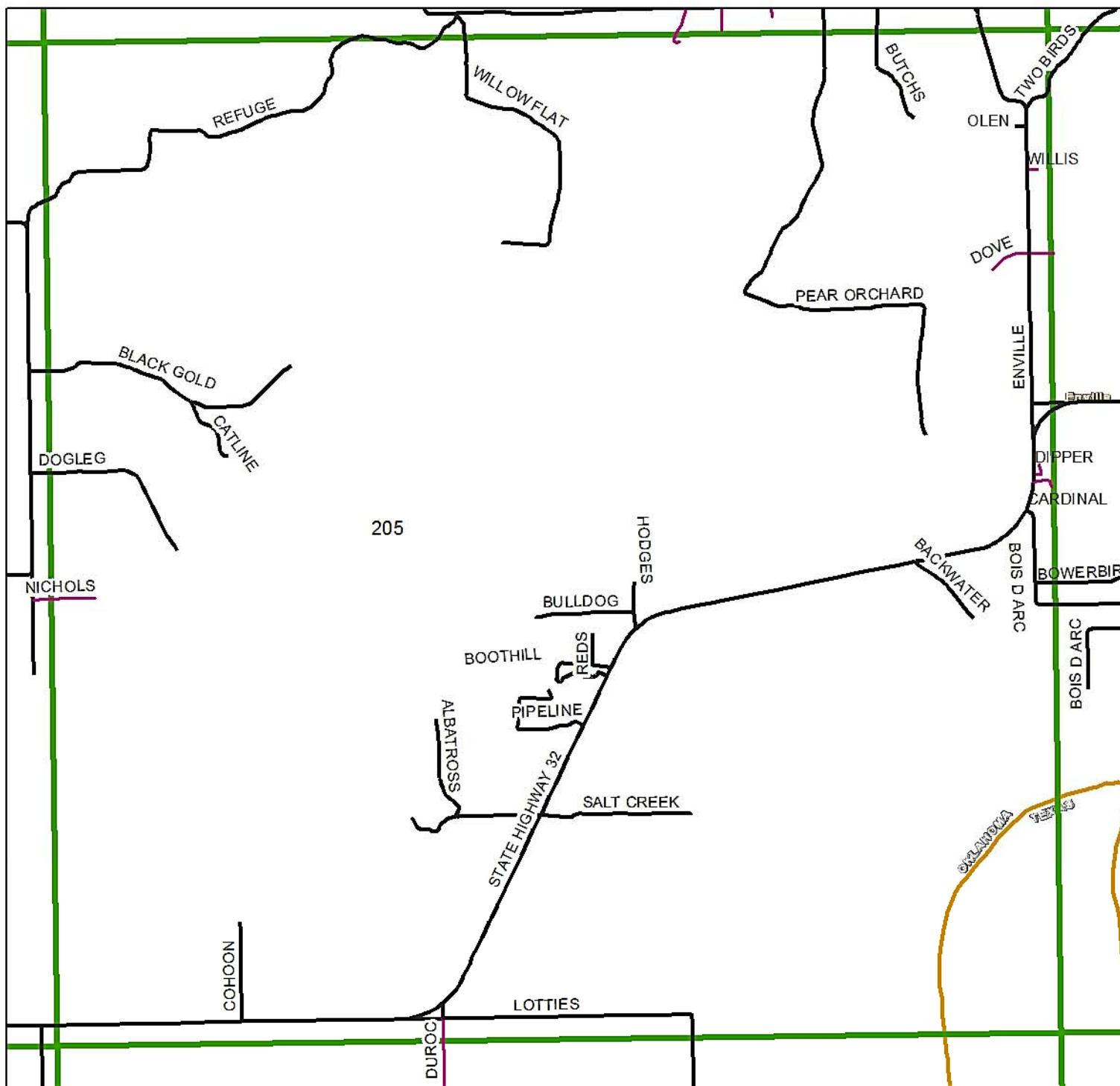
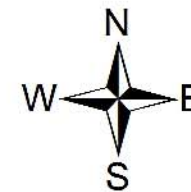

## BOX 205 STREETS

- ALBATROSS RD
- BACKWATER RD
- BLACK GOLD RD
- BOIS D ARC RD 6855-6537
- BOOTHILL RD
- BOWER BIRD RD 2903-2998
- BULLDOG RD
- BUTCHS RD
- CARDINAL LN
- CATLINE RD
- COHOON RD
- DIPPER LN
- DOVE LN
- DUROC LN
- ENVILLE RD 4078-5998
- HODGES RD
- LOTTIES RD 5134-5998
- OLEN RD
- PEAR ORCHARD RD
- PIPELINE RD
- REDS RD
- REFUGE RD
- SALT CREEK RD
- STATE HIGHWAY 32  
2854-7999
- TWO BIRDS RD 2676-2998
- WILLIS LN
- WILLOW FLAT RD

# BOX 206

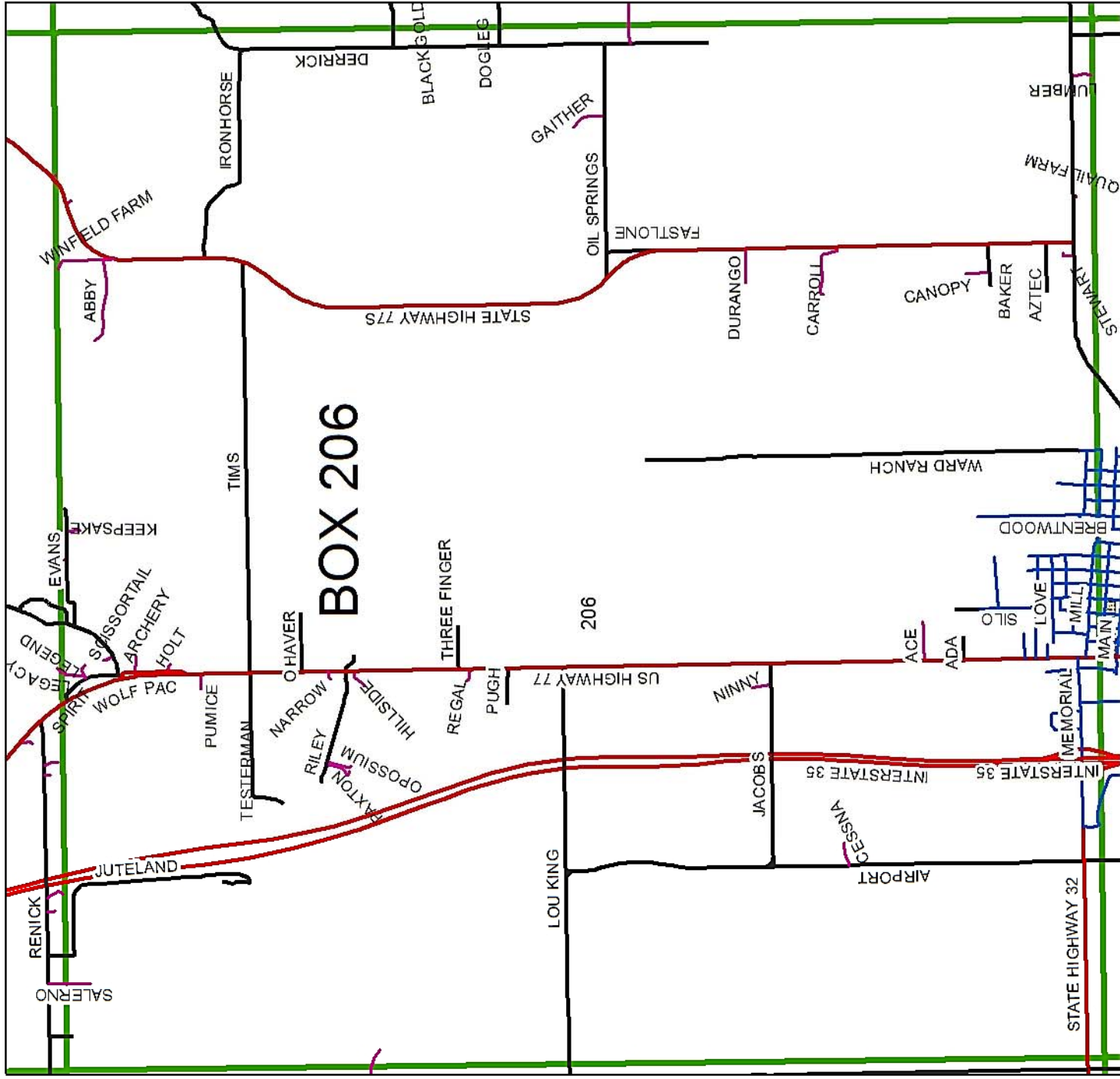
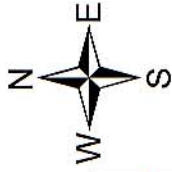

## BOX 206 STREETS

- ABBY LN
- ACE LN
- ADA LN
- AIRPORT RD 6543-8999
- ARC CEMETERY RD
- ARCHERY LN
- AZTEC RD
- BAKER RD
- BLACK GOLD RD
- CANOPY LN
- CARROLL LN
- CESSNA LN
- CITY OF MARIETTA

- DERRICK RD
- DOGLEG RD
- DURANGO RD
- FASTLINE RD
- GAITHER LN
- HILLSIDE LN
- HOLT LN
- I-35
- IRONHORSE RD
- JACOBS RD
- JUTELAND RD
- KEEPSAKE LN
- LOU KING RD 1100-12999
- LOVES VALLEY RD 9000-9065

- LUMBER LN
- NARROW LN
- NICHOLS LN
- NINNY LN
- OIL SPRINGS RD
- OPOSIUM LN
- PAXTON LN
- PUGH RD
- PUMICE LN
- QUAIL FARM LN
- REFUGE RD
- REGAL LN
- SCISSORTAIL LN
- SPIRIT RD

- STATE HIGHWAY 32
- 8000-9613 / 11795-12999
- STEWART LN
- TESTERMAN RD
- THREE FINGER RD
- TIMS RD
- US HIGHWAY 77
- 4338-8387
- WINFIELD FARM LN
- WOLFPAC RD

# BOX 207

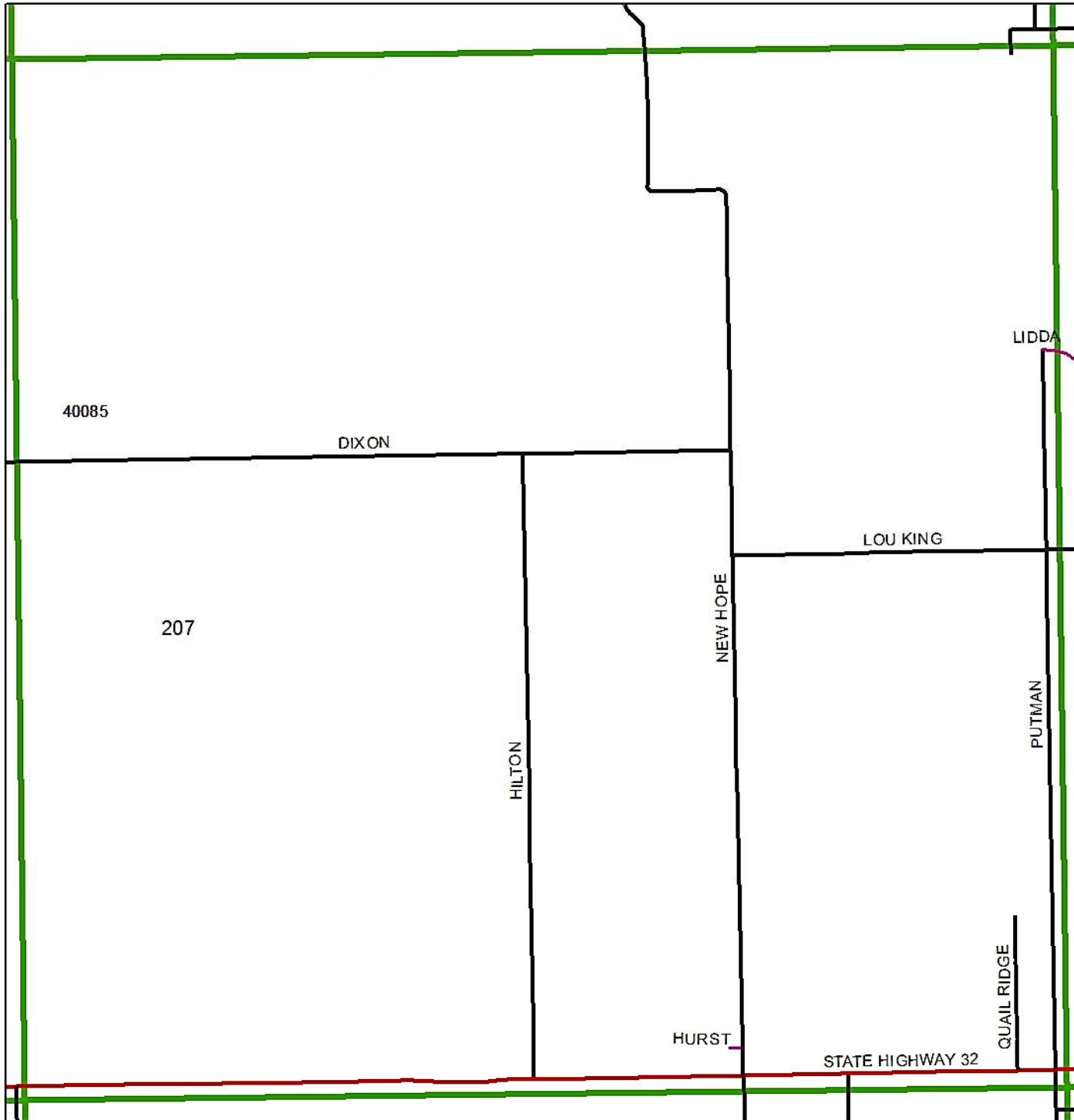

## BOX 207 STREETS

- DIXON RD 14500-17939
- HILTON RD
- HURST LN
- LIDDA LN
- LOU KING RD 13000-14449
- NEW HOPE RD 3850-9077
- PUTMAN RD
- QUAIL RIDGE RD
- STATE HIGHWAY 32  
13000-17999

# BOX 300



## BOX 300 STREETS

- ALLEN RD
- BADGER RD
- DOVER RD
- FREEMAN RD
- INDIAN TRAIL RD 13000-14091
- JACKRABBIT RD
- LATIMER DR
- LINDAL LN
- LONG RD
- MCGEHEE RD 13000-13499
- MCKAY RD
- NEW HOPE RD 9000-9253
- SHADY DALE 12978-13171



# BOX 301



## BOX 301 STREETS

- ANSON DR
- ANTELOPE LN
- ATKINS LN
- BOURBON ST
- BROKEN ARROW DR
- CANTON DR
- CEMETERY RD
- CHENILLE LN
- CHOCTAW ST
- CITY OF MARIETTA
- CLEM DR
- CLIFTON 12000-13999
- COON RD
- D RANCH RD
- FOSSIL CREEK DR
- FOX HOLLOW RD
- FOXTAIL DR
- HERITAGE LN
- INDIAN TRAILS 11464-12999
- KEYS RD
- LINDAL LN
- LOVES VALLEY RD 9000-9685
- MCGEHEE RD 8000-12999
- MINK LN
- PEANUT RD
- S HIGHWAY 77 100-1216
- SCOTCH ST
- SHADY DALE 11000-12977
- SILVER CREEK DR
- SINCLAIR LN
- TURKEY HATCHERY RD
- US HIGHWAY 77 1000-14075
- VONDER LN

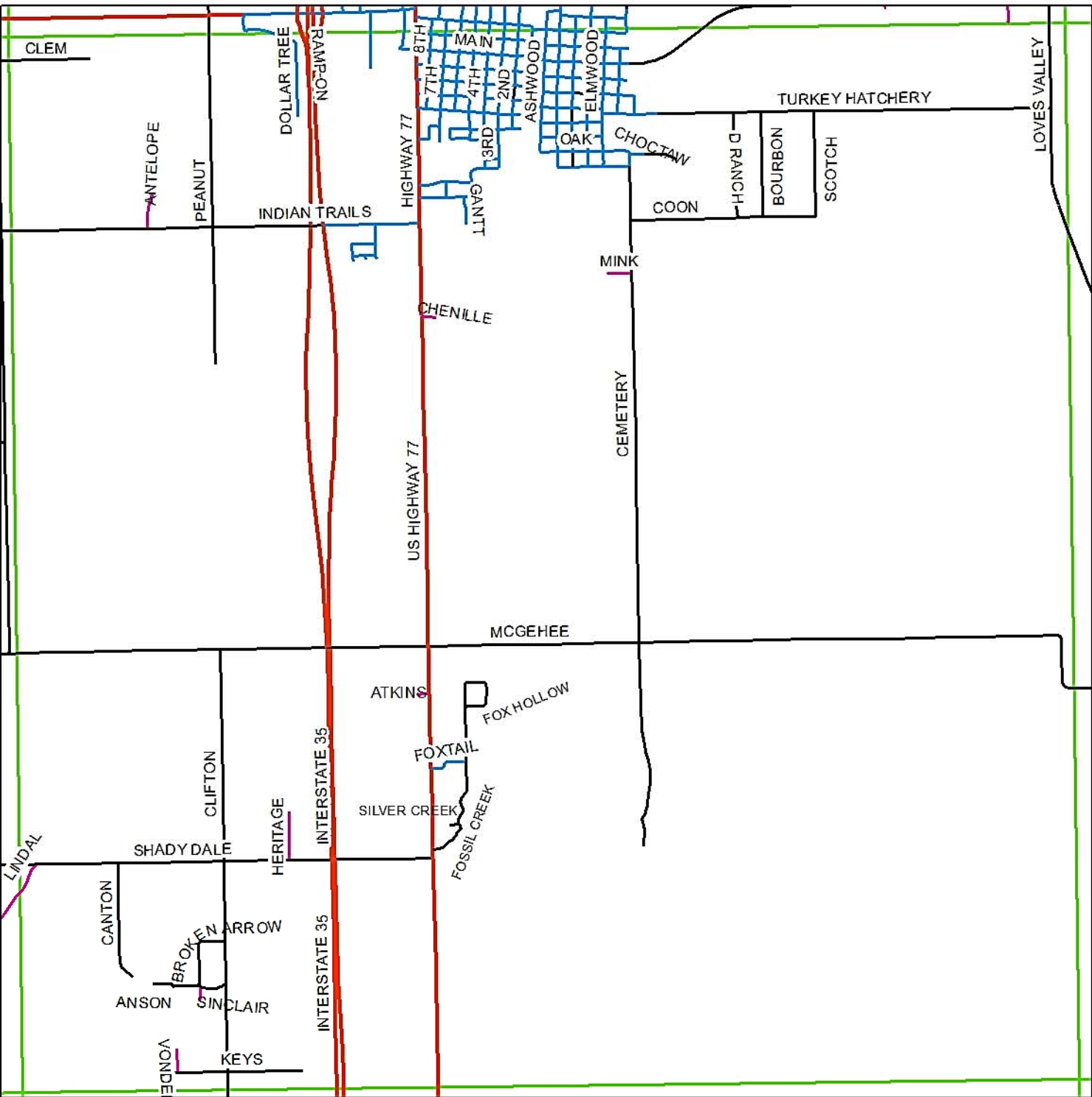

# BOX 302



## BOX 302 STREETS

ARCADIA RD

FLOOD RD

GENE BOND RD

GROVE RD

LOTTIES RD 4770-5133

LOVES VALLEY RD 9685-14115

MAGNUM RD

MARSHALL RD

MCALESTER RD

PARKER RD

RALSTON RD

STILLWATER RD 13000-14123

TIPTON RD

TUCKS FERRY RD 13000-14067

WALLACE RD

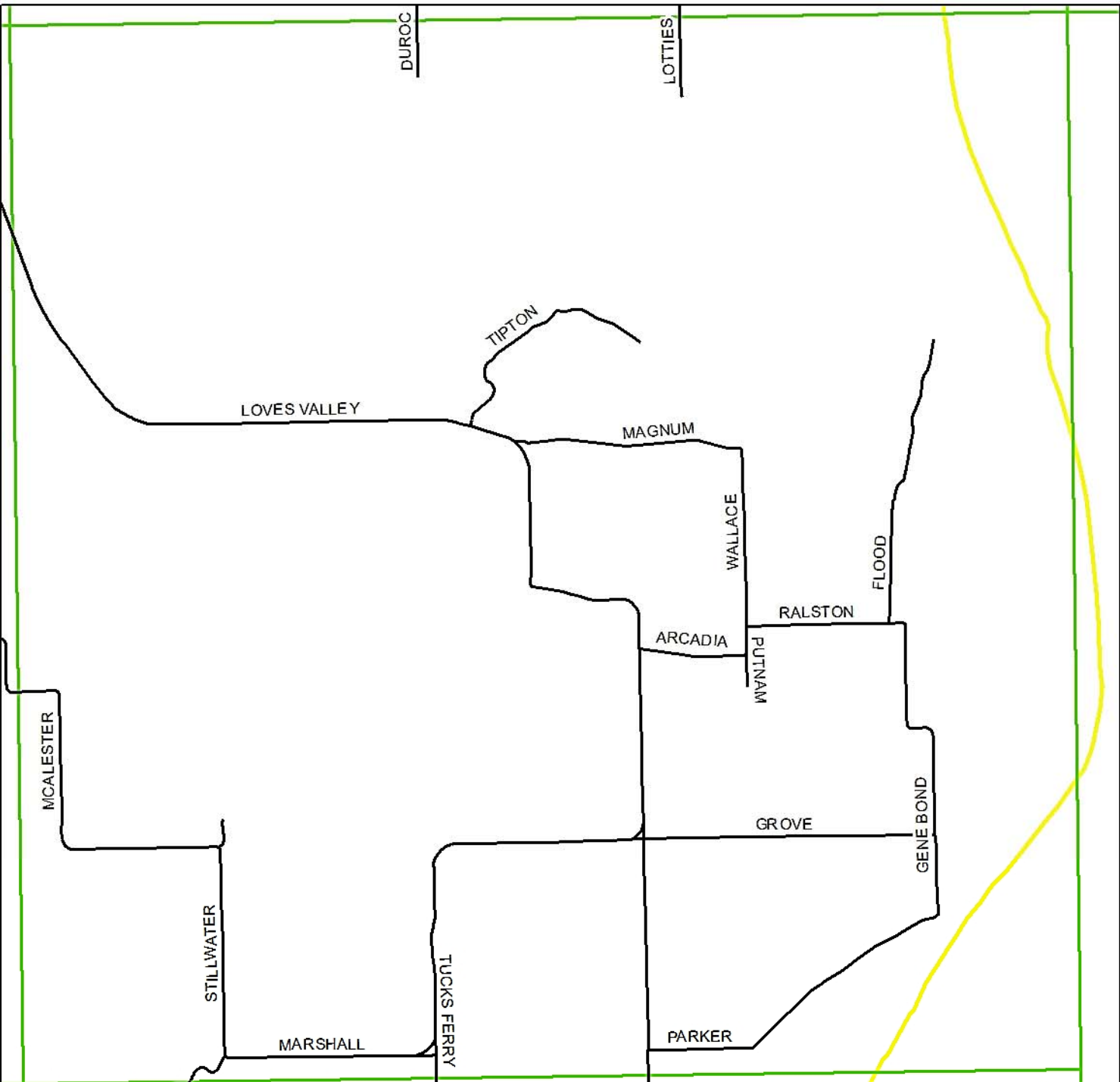

# BOX 303

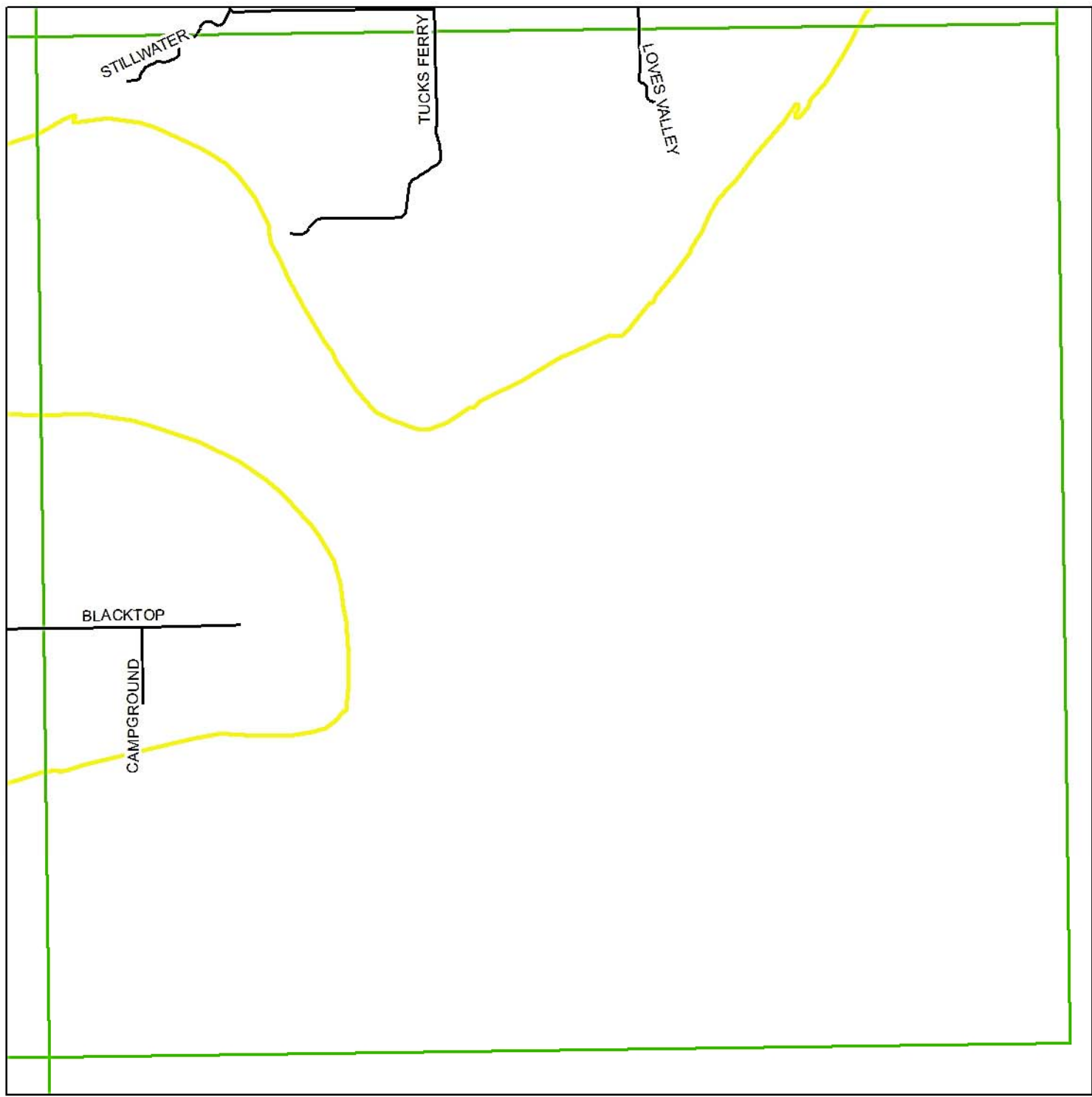

BOX 303

BLACKTOP RD 7030-7973

CAMPGROUND RD

LOVES VALLEY RD 14116-14499

STILLWATER RD 14124-14364

TUCKS FERRY RD 14068-15011

# BOX 304

BOX 304

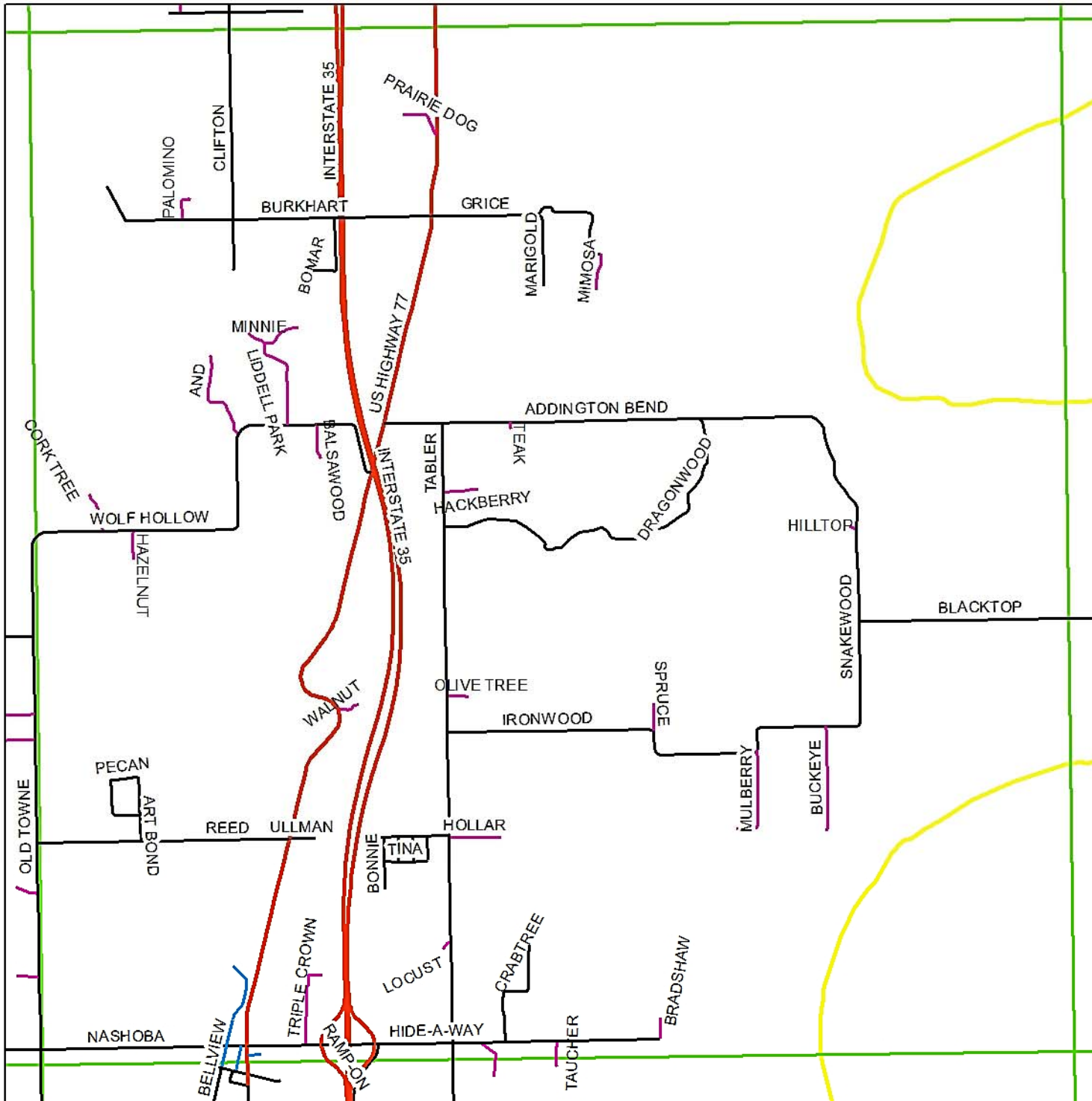

- ADDINGTON BEND AND LN
- ANGEL VIEW ST
- ART BOND RD
- BALSAWOOD LN
- BELLVIEW ST 18615-19104
- BLACKTOP RD 7974-8999
- BOMAR RD
- BONNIE ST
- BRADSHAW LN
- BUCKEYE LN
- BURKHART RD 11508-12615
- CLIFTON RD
- CORKTREE LN
- CRABTREE RD
- CROWN VIEW ST
- DEERVIEW ST
- DRAGONWOOD RD
- GINGER ST
- GRICE RD
- HACKBERRY LN
- HAZELNUT LN
- HIDE-A-WAY RD
- HILLTOP LN
- HOLLAR LN
- HUTCHINSON ADDITION
- IRONWOOD
- LIDDELL PARK DR
- LOCUST LN
- LOU ST
- MARIGOLD RD
- MARY ST
- MIMOSA LN
- MINNI LN
- MULBERRY LN
- NASHOBA 12000-12999
- OLIVE TREE LN
- PALOMINO LN
- PECAN RD
- PRAIRIE DOG LN
- REED RD
- SNAKEWOOD RD
- SPRUCE LN
- SUMAC LN
- TABLER RD 16000-18999
- TAUCHER LN
- TEAK LN
- TINA LN
- TRIPLE CROWN LN
- ULLMAN RD
- US HIGHWAY 77 14076-19089
- WALNUT LN
- WOLF HOLLOW RD

# BOX 305

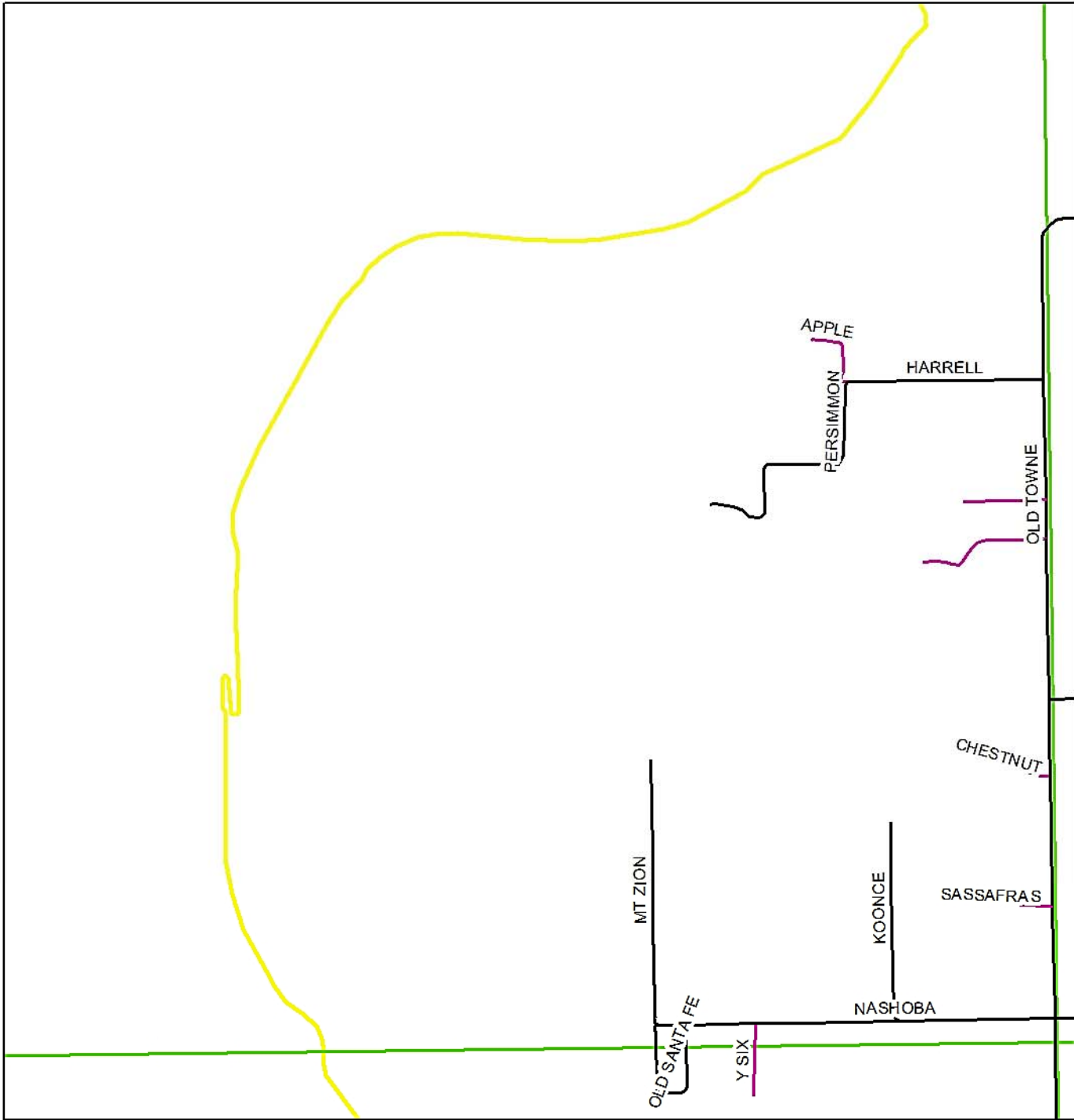

- BOX 305
- APPLE LN
- CHESTNUT LN
- ELDERBERRY LN
- HARRELL RD
- KOONCE RD
- LEDBETTER LN
- MT ZION DR
- NASHOBA 13000-14253
- OLD SANTA FE TRL
- OLD TOWNE RD 16528-18999
- PERSIMMON LN
- SASSAFRAS LN
- Y SIX LN

BOX 306

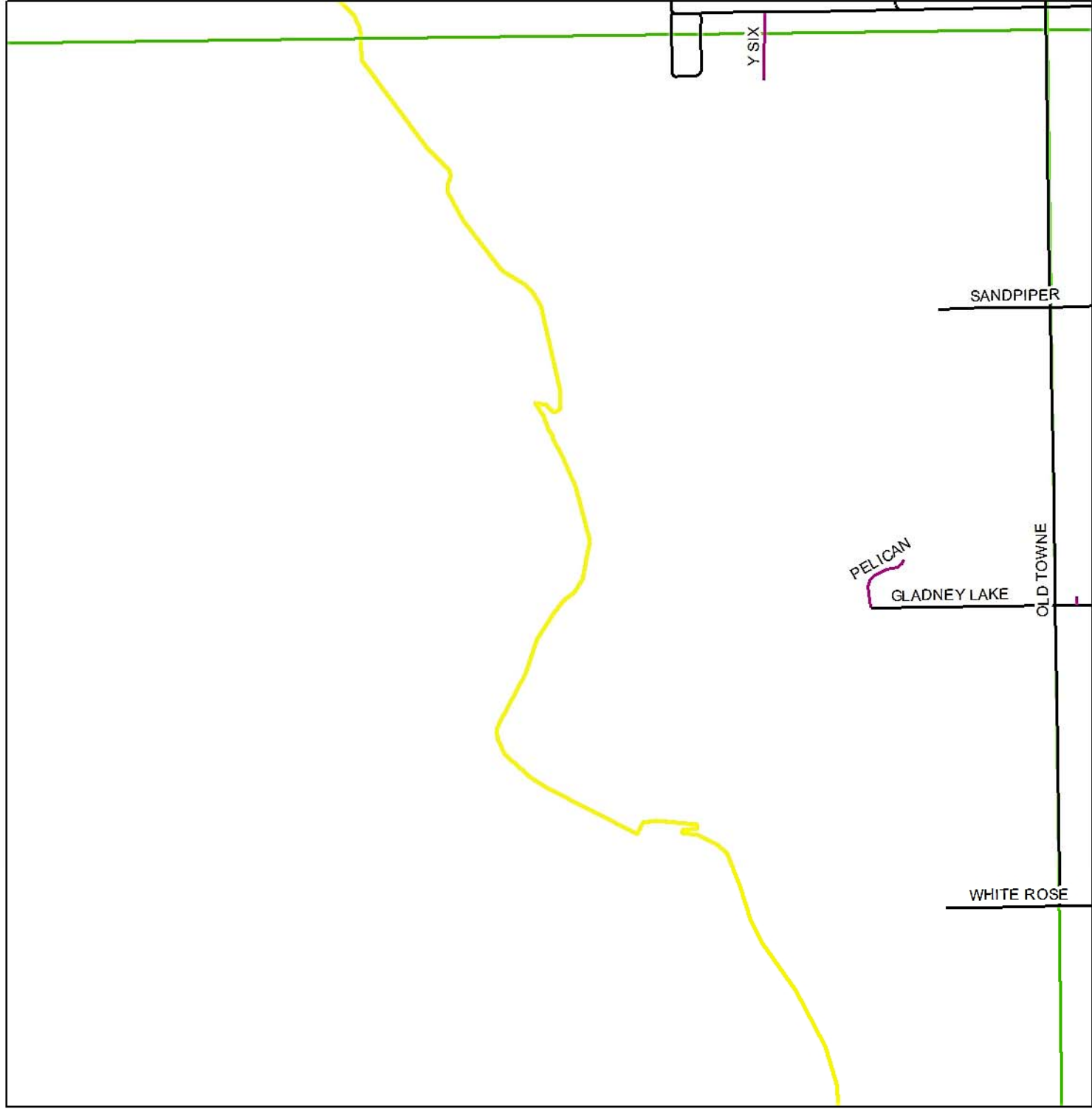

BOX 306

GLADNEY LAKE RD 13000-13617

OLD SANTA FE RD

OLD TOWNE RD 19000-21999

PELICAN LN

SANDPIPER RD 13000-13243

WHITE ROSE RD 13000-13381

SANDPIPER

OLD TOWNE

WHITE ROSE

PELICAN

GLADNEY LAKE

Y SIX

# BOX 307

BOX 307

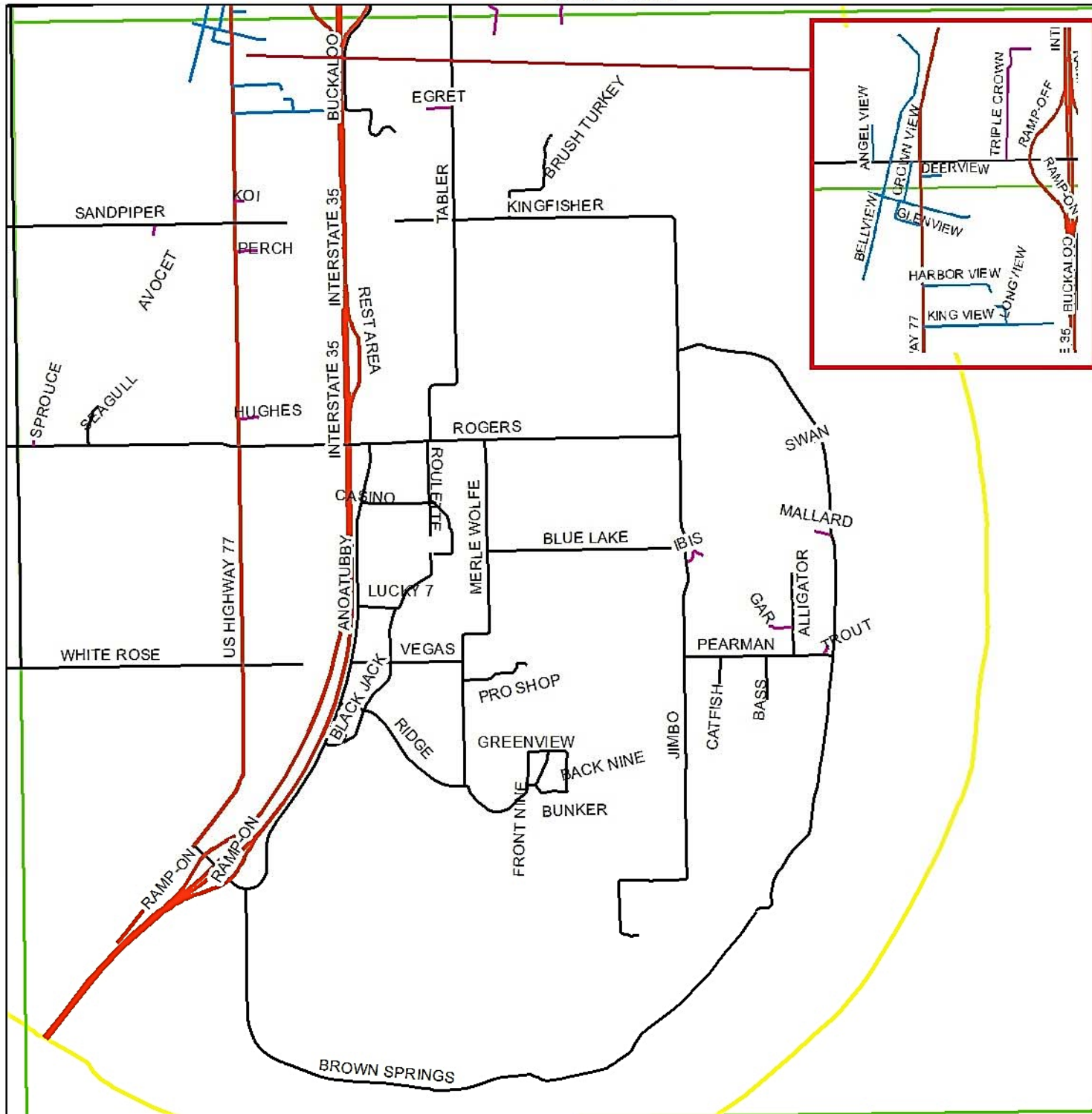

- ALLIGATOR RD
- ANOATUBBY WAY
- AVOCET LN
- BACK NINE RD
- BASS DR
- BELLVIEW ST 19105-19375
- BIRDIE DR
- BLACK JACK RD
- BLUE LAKE RD
- BROWN SPRINGS
- BRUSH TURKEY RD
- BUCKALOO RD
- BUNKER DR
- CASINO DR
- CATFISH DR
- EGRET LN
- FAIRVIEW ST
- FRONT NINE RD
- GAR LN
- GLADNEY LAKE RD 12000-12999
- GLENVIEW ST
- GREENVIEW RD
- HARBOR VIEW ST
- HUGHES LN
- IBIS LN
- JIMBO RD
- KINGFISHER DR
- KINGVIEW ST
- KOI LN
- LUCKY 7 RD
- MERLE WOLFE
- OLD TOWNE RD 19000-21999
- PEARMAN RD
- PERCH LN
- PRO SHOP RD
- RIDGE RD
- ROGER RD 10000-11999
- ROULETTE RD
- SANDPIPER RD 11771-12999
- SEAGULL DR
- SPROUCE LN
- SWAN LN MALLARD LN
- TABLER 19000-20999
- TROUT LN
- US HIGHWAY 77 1900-23249
- VEGAS RD
- WHITE ROSE RD 11720-12999
- WORLD WAY

# CITY OF MARIETTA

CITY OF MARIETTA

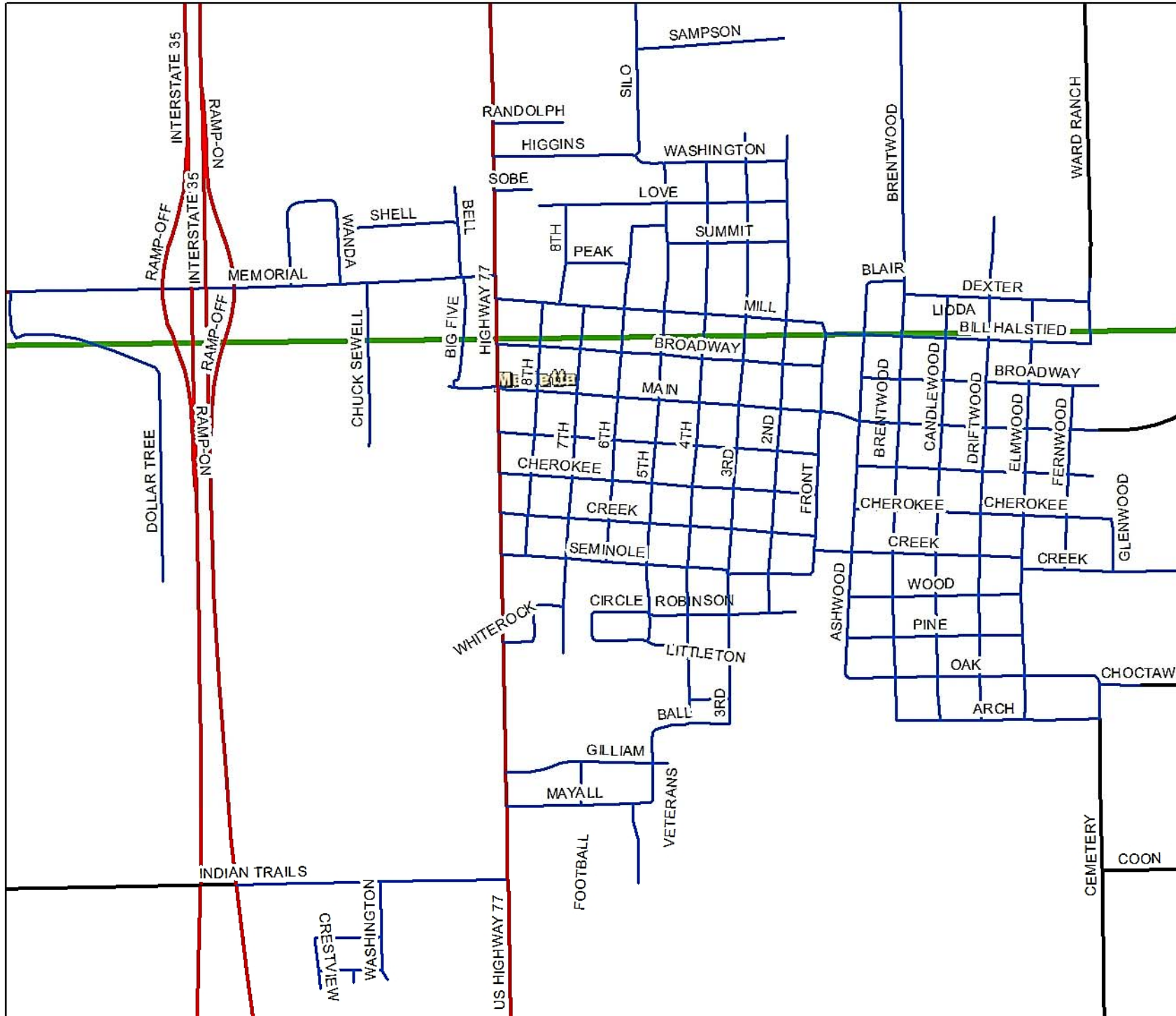

- ARCH ST
- ASHWOOD AVE
- BALL
- BELL
- BIG FIVE RD
- BILL HALSTIED ST
- BLAIR ST
- BRENTWOOD AVE
- BROADWAY ST
- C E COLSTON DR
- CANDLEWOOD AVE
- CEMETERY RD
- CHEROKEE ST
- CHICKASAW ST
- CHOCTAW ST
- CHUCK SEWELL
- CIRCLE
- CREEK ST
- CRESTVIEW AVE
- DEXTER ST
- DOLLAR TREE RD
- DRIFTWOOD AVE
- ELMWOOD AVE
- FOOTBALL WAY
- FRONT AVE
- GANTT AVE
- GILLIAM ST
- GLENWOOD AVE
- HIGGINS ST
- HIGHWAY n 77 100-1220
- HIGHWAY S 77 100-1216
- INDIAN TRAILS
- 11000-11463
- LITTLETON ST
- LOVE ST
- MAIN ST E 1-1611
- MAIN ST W 100-908
- MAYALL ST
- MEADOW PARK RD
- MEADOW PARK CT
- MEMORIAL
- MILL ST
- OAK ST
- PEAK ST
- PINE ST
- RANDOLPH ST
- RIDGVIEW DR
- ROBINSON ST
- SAMPSON RD
- SEMINOLE ST
- SHELL
- SILLO AVE
- SOBE ST
- SUMMIT ST
- VERERANS AVE
- WANDA
- WARD RANCH RD
- WASHINGTON PKWY
- WASHINGTON ST
- WHITEROCK ST
- WOOD ST



## FALCONHEAD STREETS

ABERDEEN DR	CORDELL CIR	RHONDA CIR	MASTERS DR	RYAN RD
ALTUS PL	CULP DR	HAMM PL	MCCLAIN PL	SABINE PL
ANADARKO DR	CUSTER DR	HAYWICK DR	MCCLURE CIR	SALISAW PL
APACHE PL	CUTOFF PASS DR	HAYWICKK PL	MCKINNEY CIR	SANTA FE DR
ARROWHEAD DR	DARRELL DR	HICKORY PL	MILBURN DR	SAPULPA DR
ASH PL	DEWEY DR	HOBART PL	MIAMAI PL	SHADY BROOK RD
ASHLEY GARDENS DR	DIAMON PL	HOLIDAY DR	MURRAY PL	SIMPSON PL
ASPEN PL	DIAMONDHEAD PL	HOLLIS PL	MUSKOGEE DR	STEPHENS DR
BALMERINO PL	DIAMONDHEAD DR	HUNTLY DR	NECHES PL	SULPHUR DR
BANKSIDE DR	DOGWOOD DR	IDABEL PL	NEOSHO PL	SYCAMORE AVE
BEAVER DR	DRAKE DR	IVERNESS DR	NOWATA PL	TALGOA PL
BIRCH PL	DUNCAN DR	JEANNE PL	OKEMAH PL	TAYLOR DR
BLACKHALL DR	DUNVERNY DR	JESSEE PL	OKMULGEE CIR	TRINITY PL TULSA DR
BLAIR PL	CURANT DR	JOYE PL	PATTON PL	TURNER CIR
BOISE DR	ELM PL	JUNIPER PL	PAWHUSKA PL	TUSCON PL
BONNELL PL	ENID PL	KENNOWAY LOOP	PEBBLE BEACH DR	VACATION DR
BONNY BANK DR	EUFAULA PL	KIAMICHI PL	PECOS PL	VALLEY VIEW DR
BRADY DR	FAIRWAY DR	LAKEVIEW DR	PERRY PL	VICKIE PL
BRAZOS PL	FALCON DR	LAMAR LN	PIEDMONT PL	VINTA PL
BUFFALO PL	FALCONHEAD CIR	LARAMIE DR	PIONEER PL	WACO PL
CACTUS DR	FALCONHEAD DR	LAWTON LN	PLATTE PL	WAGONER WAY
CALLANDER DR	FALCONHEAD ACCESS	LEON LN	PONCA PL	WALTERS WAY
CALVARY DR	FRANKS PL	LILAC PL	POPLAR DR	WASHITA WAY
CANADIAN DR	FRONTIER DR	LOCHSIDE DR	POTEAU DR	WATONGA WAY
CARTER PL	GARVIN PL	LOGAN LN	PRAIRIE PL	WAURIKA DR
CHANDLER CT	GAYE PL	LOUISE DR	PRESTON PL	WAYNE DR
CHICKASHA CI	GLENDEVON PL	MADILL WAY	PRYOR PL	WENDYL WAY
CHISHOLM TRL	GLENTURRET DR	MAGNOLIA AVE	QUANAH DR	WEWOKA DR
CIMARRON CIR	GOLF CLUB DR	MARGARET RD	RED RIVER AVE	WHITE OAK PL
COLGATE T	GRAND WALL	MARITETTA CIR	RED ROCK RD	WINCHESTER DR
COMANCHE DR	GREENBRIAR AVE	MARTIN DR	REDBUD LN	YUKON DR
CONWAY PL	GUYMON PL	MARY ANNE DR	RIO RD	

# BOX 112

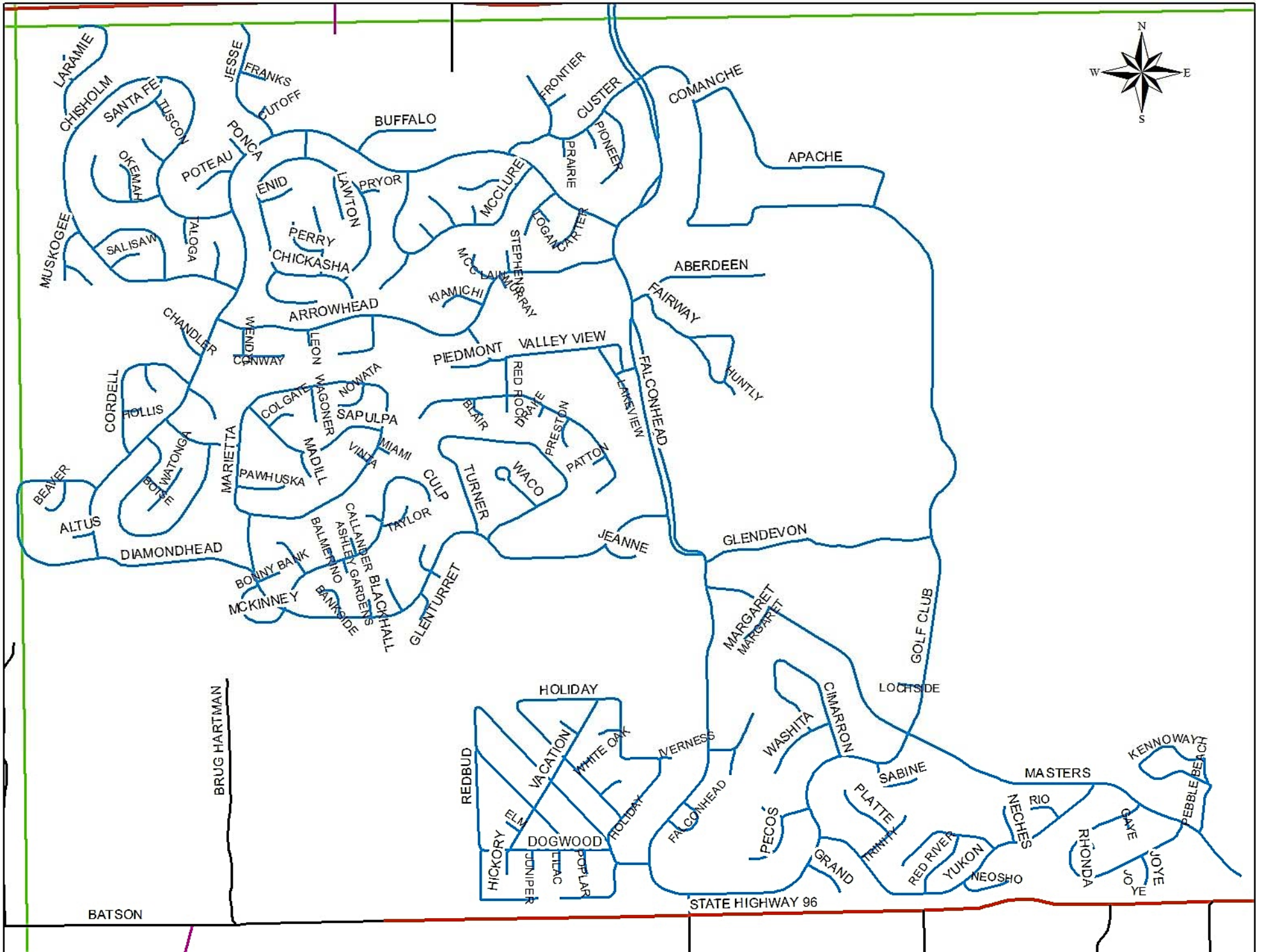



A		BASS DR	111	BUCKEYE LN	304	CLYDESDALE LN	106	DUNBAR RD	105	FRALEY ST	206 MAR
A J HALLUM RD	202	BATSON RD	111	BUCKSKIN DR	105	COHOON DR	205	DUNCAN DR	112 FH	FRANKS	112 FH
ABBY LN	206	BEAVER DR	112 FH	BUFFALO PL	112 FH	COLGATE CT	112 FH	DUNVERNY DR	112 FH	FRAZIER RD	114
ABERDEEN DR	112 FH	BELL ST	301 MAR	BULL SNAKE DR	100	COLLEGE ST	110 LEON	DURANGO LN	206	FREEMAN RD	300
ABNER RD	104	BELLEVILLE RD	108/109	BULLDOG RD	205	COMANCHE DR	112 FH	DURANT DR	112 FH	FRONT NINE RD	307
ACE LN	206	BELLVIEW ST	304 TVILLE	BUNKER DR	307	COMMERCE ST	110 LEON	DUROC LN	205	FRONTIER	112 FH
ACORN HOLLOW LN	202	BIG FIVE AVE	MAR	BURKHART RD	304	CONROY RD	202	E		FURRH RD	107
ADA LN	206	BILL HALSTIED ST	301 MAR	BURLINGTON RD	201	CONWAY PL	112 FH	E 2050 RD	100	G	
ADDINGTON BEND RD	304	BIRCH PL	112 FH	BURNEY RD	112	COON RD	301	E 2090 RD	108	GAITHER LN	206
ADOBE LN	202	BIRDIE DR	307	BURNEYVILLE RD	112	COPPER LN	111	E BROADWAY ST	301 MAR	GANTT ST	301 MAR
AGATE RD	110	BLACK GOLD RD	205	BUSH LN	107	COPPERHEAD RD	100	E CHEROKEE ST	301 MAR	GAR LN	307
AIRPORT RD	206	BLACK JACK RD	307	BUTCHS RD	205	CORDELL CIR	112 FH	E CHICKASAW ST	301 MAR	GARDENVIEW ST	201
ALBATROSS DR	205	BLACKHALL DR	112 FH	BUZZARDS ROOST	201	CORK TREE LN	304	E CREEK ST	301 MAR	GARNET RD	113/114
ALDER	100	BLACKTOP RD	303	C		COTTONWOOD ST	100 ORR	E MAIN ST	301 MAR	GARVIN PL	112 FH
ALLEN RD	300	BLAIR PL	112 FH	C E COLSTON DR	206 MAR	COURTNEY RD	108	E PONDEROSA PL	112	GAYE PL	112 FH
ALLIGATOR RD	307	BLAIR ST	301 MAR	CACTUS DR	112	COYLE DR	111	EAGLE CLAW LN	204	GENE BOND RD	302
ALTUS	112 FH	BLAKELY RD	113	CALDWELL RD	201	CR RANCH LN	200	EAGLEVIEW LN	201	GIDRAN LN	201
AMBER RD	113	BLAZER LN	207	CALLANDER DR	112 FH	CRABTREE RD	304	EASTMAN RD	105	GILLIAM ST	301 MAR
AMETHYST ST	110	BLUE JAY LN	202	CALVARY DR	112 FH	CRANE RD	103	EASTRIDGE ST	110 LEON	GINGER ST	304
ANADARKO DR	112 FH	BLUE LAKE RD	307	CAMPBELL RD	200	CRESTVIEW AVE	301 MAR	ED LYDE RD	202	GLADNY LAKE RD	306/307
AND LN	304	BLUEBIRD LN	201	CAMPGROUND RD	307	CRIMSON LN	202	EDGEWOOD RD	202	GLENDEVON DR	112 FH
ANGEL VIEW ST	304 TVILLE	BLUERIDGE ST	110	CANADIAN DR	112 FH	CROWN VIEW ST	304 TVILLE	EGRET LN	307	GLENRIDGE ST	110 LEON
ANOATUBBY WAY	307	BLUFF RD	112	CANAL RD	110	CULP DR	112 FH	EGYPT RD	111	GLENTURRET DR	112 FH
ANSON DR	301	BOAT DOCK RD	201	CANOPY LN	206	CUSTER DR	112 FH	EISENHOWER LN	107	GLENVIEW ST	307 TVILLE
ANTELOPE LN	301	BOIS D ARC RD	205	CANTON DR	301	CYPRESS AVE	112 FH	ELDERBERRY LN	305	GLENWOOD AVE	301 MAR
APACHE PL	112 FH	BOISE DR	112 FH	CANYON RD	100	D		ELM PL	112 FH	GOLD RD	111
APPALOOSA LN	207	BOMAR RD	304	CARDINAL LN	205	D RANCH RD	301	EMERALD LN	113	GOLF CLUB DR	112 FH
APPLE LN	305	BONANZA	112	CARROLL LN	206	DANIELS LN	200	EMU LN	204	GRAND WALL	112 FH
ARABIAN LN	105	BONNELL PL	112 FH	CARTER PL	112 FH	DANUBE LN	106	ENID PL	112 FH	GRANT RD	109/110
ARCADIA RD	302	BONNIE ST	304	CASINO DR	307	DARRELL DR	112 FH	ENVILLE CUT RD	205	GRASSBUR RD	114
ARCH ST	301 MAR	BONNY BANK DR	112 FH	CASPIAN LN	111	DAVIS RD	202	ENVILLE RD	205	GREENBRIAR AVE	112 FH
ARCHERY DR	206	BOOTHILL LOOP	205	CATFISH DR	307	DEER RIDGE ST	110 LEON	EUFAULA PL	112 FH	GREENVIEW RD	307
ARK CEMETERY RD	205	BOURBON ST	301	CATLINE RD	205	DEERVUE ST	304 TVILLE	EVANS RD	201	GREENVILLE RD	206
ARROW RIDGE	110	BOWERBIRD LN	205	CEDAR RIDGE ST	110	DENTON DR	112	F		GRICE RD	304
ARROWHEAD DR	112 FH	BRADSHAW LN	304	CEDAR ST	100 ORR	DERRICK RD	206	FAIRVIEW ST	307 TVILLE	GROVE RD	302
ART BOND RD	304	BRADY DR	112 FH	CEMETERY RD	301	DEWEY DR	112 FH	FAIRWAY DR	112 FH	GUNSMOKE RD	112
ASH PL	112 FH	BRASS RD	112	CESSNA LN	206	DEXTER ST	206 MAR	FALCON RD	112	GUYMON PL	112 FH
ASHLEY GARDENS DR	112 FH	BRAZOS PL	112 FH	CHANDLER CT	112 FH	DIAMOND LN	111	FALCONHEAD ACC	112 FH	H	
ASPEN PL	112 FH	BRIDLE LN	200	CHENILLE LN	301	DIAMONDHEAD DR	112 FH	FALCONHEAD CIR	112 FH	HACKBERRY LN	304
ATKINS LN	301	BRISTOL LN	200	CHESTNUT LN	305	DIAMONDHEAD PL	112 FH	FALCONHEAD DR	112 FH	HACKNEY LN	201
AVOCET LN	307	BROCK RD	200	CHICKADEE DR	202	DIPPER LN	205	FASTLINE RD	206	HAMM PL	112 FH
AYRES LN	103	BROKEN ARROW DR	301	CHICKASHA CIR	112 FH	DIXON RD	105/207	FEATHERSTONE LN	201	HAMPTON RD	201
AZTEC RD	206	BRONZE RD	111	CHISHOLM TRL	112 FH	DOGLEG RD	206	FERRIS LN	201	HARBOR VIEW ST	307 TVILLE
B		BROOKHOLLOW RD	200	CHOCTAW ST	301 MAR	DOGWOOD CANYON LN	202	FIG	100 ORR	HARMONY LN	201
BACK NINE	307	BROWN SPRINGS RD	307	CHUCK SEWELL DR	206 MAR	DOGWOOD DR	112 FH	FINCH LN	202	HARRELL RD	304
BACKWATER	205	BRUG HARTMAN RD	112	CHURCH ST	110 LEON	DOLLAR TREE WAY	206 MAR	FLOOD RD	302	HARRIS DR	202
BADGER	300	BRUMBY LN	111	CIMARRON CIR	112 FH	DORY DR	105	FOOTBALL WAY	301 MAR	HAYWICK DR	112 FH
BAKER RD	206	BRUSH TURKEY RD	307	CINNABAR CIR	110 LEON	DOVE LN	205	FORD RD	110	HAYWICK PL	112 FH
BALL ST	301 MAR	BRUSHY MOUND LN	108	CIRCLE DR	301 MAR	DOVER RD	301	FOREST RIDGE ST	110 LEON	HAZELNUT LN	304
BALMERINO PL	112 FH	BUCCANEER DR	104	CLEM DR	301	DRAGONWOOD RD	304	FOSSIL CREEK DR	301	HERITAGE LN	301
BALSAWOOD LN	304	BUCHANAN CIR	110	CLIFTON RD	301	DRAKE DR	112 FH	FOX HOLLOW RD	301	HICKMAN HL	200
BANKSIDE DR	112 FH	BUCKALOO RD	307	CLOVER LN	202	DUMAS LN	105	FOXTAIL DR	301	HICKORY PL	112 FH

HICKS RD	111	KENNEDY RD	107	LUCKY 7 RD	307	N 5TH AVE	206 MAR	PEACOCK LN	201	RED ROCK RD	112 FH
HIDE-A-WAY RD	304	KENNOWAY LOOP	112 FH	LUMBER LN	206	N 6TH AVE	206 MAR	PEAK ST	206 MAR	REDBIRD RD	201
HIGGINS ST	206	KEYS RD	301	M		N 7TH AVE	206 MAR	PEANUT RD	301	REDBUD LN	112 FH
HIGHRIDGE	110 LEON	KIAMICHI PL	112 PL	MADILL WAY	112 FH	N 8TH AVE	206 MAR	PEAR ORCHARD R	205	REDHAWK RD	112
HILLSIDE LN	206	KING VIEW ST	307 TVILLE	MAGNOLIA AVE	112 FH	N ASHWOOD AVE	206 MAR	PEARMAN RD	307	REDS RD	205
HILLTOP LN	304	KINGBIRD DR	202	MAGNUM RD	302	N BRENTWOOD AVE	206 MAR	PEBBLE BEACH RD	112 FH	REDWOOD ST	100 ORR
HILTON RD	207	KINGFISHER DR	307	MAHOGANY RD	100	N CANDLEWOOD AVE	206 MAR	PECAN RD	304	REED RD	111
HOBART RD	112 FH	KINGRIDGE ST	110 LEON	MALLARD LN	307	N DRIFTWOOD AVE	206 MAR	PECOS PL	112 FH	REFUGE RD	205
HODGES RD	205	KIRK LN	206	MAPLE ST	100 ORR	N ELMWOOD AVE	206 MAR	PEERY RD	201	REGAL LN	206
HODGSON LN	100	KIRKWOOD LN	206	MARGARET RD	112 FH	N FERNWOOD AVE	206 MAR	PELICAN LN	308	RENICK RD	200/201
HOFFMAN RD	100	KOI LN	307	MARGIE PHILLIPS LN	113/114	N FRONT	206 MAR	PENNY LN	201	RENSHAW LN	201
HOLIDAY DR	112 FH	KOLACHE RD	201	MARIETTA CIR	112 FH	N HIGHWAY 77		PERCH LN	307	REST AREA RD	307
HOLLAR LN	304	KOONCE RD	305	MARIGOLD RD	304	NARROW LN	206	PERIDOT RD	111	RHONDA CIR	112 FH
HOLLIS PL	112 FH	KRISTI LN	201	MARLOVE RD	203	NASHOBA RD	304/305	PERRY PL	112 FH	RICE RD	201
HOLT LN	206	L		MARSDEN RD	200	NECHES PL	112 FH	PERSIMMON LN	305	RICHARD LEE	114
HONEYSUCKLE DR	201	LADNER	111	MARSHALL RD	302	NEOSHO PL	112 FH	PHEASANT RUN DR	202	RIDGE RD	307
HOOKER RD	110	LAKE RD	113	MARTIN DR	112 FH	NEW HOPE RD	200/207/300	PIEDMONT PL	112 FH	RIDGEVIEW DR	301 MAR
HORSESHOE LOOP	201	LAKEVIEW DR	112 FH	MARY ANNE DR	112 FH	NEWPORT RD	201	PIGEON LN	200	RILEY RD	206
HUDSON LN	201	LAMAR LN	112 FH	MARY ST	304	NICHOLS LN	206	PIKE RD	103/105/10	RIO RD	112 FH
HUGHES LN	307	LARAMIE DR	112 FH	MASTERS DR	112 FH	NICKEL RD	113	PINE ST	301 MAR	RIVER RD	113
HULL RD	106	LARIAT LN	112 FH	MAVERICK DR	112 FH	NIGHTINGALE RD	204	PIONEER PL	112 FH	RIVER RIDGE LN	307
HUMMINGBIRD LN	202	LATIMER DR	300	MAYALL ST	301	NINNY LN	206	PIPELINE RD	205	ROADRUNNER DR	202
HUNTLY DR	112 FH	LAVENDER ST	201	MCALESTER RD	303/302	NIXON LN	107	PLATINUM LN	111	ROANOKE AVE	201
HURST LN	207	LAWTON LN	112 FH	MCCLAIN PL	112 FH	NOBLE FDN RD	112	PLATTE PL	112 FH	ROBERTS AVE	100 ORR
HUTCHINS ADDITION RD	304	LEDBETTER LN	305	MCCLURE CIR	112 FH	NORSE LN	201	PLUM ST	100 ORR	ROBINSON ST	301 MAR
I		LEGACY RD	206	MCGEHEE RD	301	NOWATA PL	112 FH	PONCA CIR	112 FH	ROCKY ACRES RD	201
IBIS LN	307	LEGATE CEMETERY	202	MCKAY RD	300	O		POPLAR PL	112 FH	RODEO RD	107
IDABEL PL	112 FH	LEGATE RD	203	MCKINNEY CIR	112 FH	O HAVER RD	206	PORTER RD	100	ROGERS RD	307
INDIAN MERIDIAN RD	112	LEGEND LN	206	MEADOWLARK DR	202	OAK ST	301 MAR	POTEAU DR	112 FH	ROOSEVELT RD	110
INDIAN TRAILS RD	300/301	LEON CEMETERY CT	110	MEADOWPARK CT	301 MAR	OIL SPRINGS RD	206	PRAIRIE DOG LN	304	ROULETTE RD	307
IRONHORSE RD	206	LEON CEMETERY LOOP	110	MEADOWPARK RD	301 MAR	OKEMAH PL	112 FH	PRAIRIE PL	112 FH	RUBOTTOM RD	107
IRONRIDGE	110 LEON	LEON LN	112 FH	MELVIN DOUGLAS	202	OKMULGEE CIR	112 FH	PRESTON PL	112 FH	RUBY RD	113
IRONWOOD RD	304	LESTER RD	108	MEMORIAL DR	206 MAR	OLD SANTA FE TRL	305	PRO SHOP RD	307	RYAN RD	112 FH
IVERNESS DR	112 FH	LIDDA LN	207	MERLE WOLFE RD	307	OLD TOWNE RD	304/307	PRYOR PL	112 FH	S	
J		LIDDELL PARK DR	304	MESQUITE ST	100 ORR	OLEN RD	205	PUGH RD	206	S 2ND AVE	301 MAR
JACKRABBIT RD	300	LILAC PL	12 FH	MIAMI PL	112 FH	OLIVE TREE LN	304	PUMICE LN	206	S 3RD AVE	301 MAR
JACOBS RD	206/207	LINCOLN LN	106	MILBURN DR	112 FH	ONYX LN	113	PUTMAN RD	207	S 4TH AVE	301 MAR
JADE RD	114	LINDAL LN	301	MILLBANK DR	112	OPAL RD	113	PUTNAM RD	302	S 5TH AVE	301 MAR
JASMINE LN	201	LITTLETON ST	301 MAR	MIMOSA LN	304	OPPOSSUM LN	206	Q		S 6TH AVE	301 MAR
JASPER LN	106	LOCHSIDE DR	112 FH	MINK LN	303	ORIOLE LN	202	QUAIL FARM LN	206	S 7TH AVE	301 MAR
JEANNE PL	112 FH	LOCUST LN	304	MINNIE LN	304	ORR RD	100/107/108	QUAIL RIDGE RD	207	S 8TH AVE	301 MAR
JEFFERSON RD	109	LODGE RD	201	MITCHELL RD	201	OSPREY RD	204	QUANAH DR	112 FH	S ASHWOOD AVE	301 MAR
JESSE PL	112 FH	LOGAN LN	112 FH	MOCKINGBIRD RD	202	OSWALT RD	101-104/200/201	QUARTZ RD	111	S BRENTWOOD AVE	301 MAR
JIMBO RD	307	LONE OAK RD	204	MOONSTONE RD	111	OVERBROOK RD	201	R		S CANDLEWOOD AVE	301 MAR
JIMTOWN CEMETERY RD	113	LONG HOLLOW RD	104/105	MORGAN RD	103	P		RAINFORD LN	112	S COMMERCE ST	110 LEON
JIMTOWN RD	106/111	LONG RD	300	MOSEY RD	201	PAGE RD	200	RALSTON RD	302	S COUNTY LINE RD	200
JOHNSON ST	110 LEON	LONGVIEW ST	307 TVILLE	MT ZION DR	305	PALOMINO LN	304	RAN CEMETERY RD	202	SUFFOLK LN	200
JOYE PL	112 FH	LOONEY DR	112	MULBERRY LN	304	PAMPA HORSE LN	103	RAN RD	202	S ELMWOOD AVE	301 MAR
JUNERIDGE ST	110 LEON	LOTTIES RD	205	MURRAY PL	112 FH	PARKER RD	302	RANDOLPH ST	206 MAR	S FERNWOOD AVE	301 MAR
JUNIPER PL	112 FH	LOU KING RD	206/207	MUSKOGEE DR	112 FH	PARROT LN	203	RAVEN RD	112	S FRONT AVE	301 MAR
JUTELAND RD	201	LOU ST	304	N		PASCHALL RD	202	RED RIVER AVE	112 FH	S HIGHWAY 77	201/206/301/304/307
K		LOUISE DR	112	N 2ND AVE	206 MAR	PATTON PL	112 FH	RED RIVER RANCH	112	S MANNING RD	200
KEEPSAKE LN	206	LOVE ST	206	N 3RD AVE	206 MAR	PAWHUSKA PL	112 FH	RED RIVER RANCH	112	S PICKENS RD	203
KELTNER RD	110	LOVES VALLEY RD	301/302	N 4TH AVE	206 MAR	PAXTON LN	206	RED ROBIN DR	202	S STATE HIGHWAY 76	102/107/110

SABINE PL	112 FH	TALOGA PL	112 FH	WACO PL	112 FH
SALERNO LN	201	TAUCHER LN	304	WADE RD	101/106
SALINA PL	112 FH	TAWLEED RD	201	WAGONER WAY	112 FH
SALISAW PL	112 FH	TAYLOR DR	112 FH	WALER LN	200
SALT CREEK RD	205	TEAK LN	304	WALKALOOSA LN	200
SAMPSON RD	206 MAR	TESTERMAN RD	206	WALLACE RD	302
SANDPIPER RD	307/308	THOROUGHbred RD	200	WALNUT LN	304
SANTE FE DR	112 FH	THREE FINGER RD	206	WALTERS WAY	112 FH
SAPULPA DR	112 FH	TIMS RD	206	WANDA ST	206 MAR
SASSAFRAS LN	305	TINA LN	304	WARD RANCH RD	206 MAR
SCENIC STATE HIGHWAY 77	201/202	TIPTON RD	302	WASHINGTON PKWY	301 MAR
SCISSORTAIL LN	206	TOAD HOLLOW TRL	202	WASHINGTON ST	206 MAR
SCOTCH ST	301	TOMBSTONE RD	112	WASHITA WAY	112 FH
SCOTT RD	202	TOPAZ RD	114	WATER MOCASSIN RD	102/103
SEAGULL DR	307	TOPSAIL LN	200	WATONGA WAY	112 FH
SEMINOLE ST	301 MAR	TOUCAN LN	204	WAURIKA DR	112 FH
SHADY DALE RD	301	TREELINE LN	108	WAYNE DR	112 FH
SHADYBROOK RD	112 FH	TREGO RD	201	WENDYL WAY	112 FH
SHANKLES RD	112	TREVOR RD	201	WESTEND DR	111
SHELL ST	206 MAR	TRINITY PL	112 FH	WEWOKA DR	112 FH
SHORELINE RD	201	TRIPLE CROWN LN	304 TVILLE	WHALEY ST	301 MAR
SIDEWINDER LN	202	TROTTER LN	103	WHIPPOORWILL AVE	202
SILLO AVE	206 MAR	TROUT LN	307	WHITE OAK PL	112 FH
SILVER CREEK DR	301	TRUITT RD	201	WHITE RD	111
SIMMENTAL LN	205	TUCKS FERRY RD	302	WHITE ROSE RD	307
SIMPSON PL	112 FH	TUFF ST	103	WHITEROCK DR	301 MAR
SINCLAIR LN	301	TULSA DR	112 FH	WILLIS LN	205
SKYLARK DR	202	TUNDRA LN	201	WILLOW FLAT RD	205
SLOAN LN	203	TURKEY HATCHERY RD	301	WILSON CREEK RD	204
SMEE LN	204	TURNER CIR	112 FH	WINCHESTER DR	112 FH
SNAKEWOOD RD	304	TURNER ST	301 MAR	WINFIELD FARM RD	206
SOBE ST	206 MAR	TURTLE CREEK TRL	202	WOLF HOLLOW RD	304
SORGHUM CENTER RD	104/200	TUSCON PL	112 FH	WOLFPAC RD	206
SPARROW RD	112	TWITTY RD	201	WOOD ST	301 MAR
SPIRIT RD	206	TWO BIRDS RD	203/205	WORLD WAY DR	307
SPROUCE LN	307	U		Y	
SPRUCE LN	304	ULLMAN RD	304	Y SIX LN	305
STARLING LN	202	US HIGHWAY 77	201/206/301/304/307	YANKEE LN	112
STATE HIGHWAY 32	204-207/105-108	V		YILI LN	200
STATE HIGHWAY 77S	201/206	VACATION DR	112 FH	YORKTOWN DR	201
STATE HIGHWAY 89	109	VALLEY VIEW DR	112 FH	YUKON DR	112 FH
STATE HIGHWAY 96	112	VEGAS RD	307	Z	
STEPHENS DR	112 FH	VELVET TRL	102	ZINC RD	113
STEWART LN	206	VETERANS AVE	301 MAR	ZIRCUN LN	111
STILLWATER DR	302/303	VICKIE PL	112 FH		
S DRIFTWOOD AVE	301 MAR	VINA RD	204		
STOCKTON RD	102/106/111	VINSON RD	203/204		
STRADFORD RD	105	VINTA PL	112 FH		
SULPHER DR	112 FH	VONDER LN	301		
SUMAC LN	304	W			
SUMMIT ST	206 MAR	W BROADWAY ST	206 MAR		
SUNSTONE RD	111	W CHEROKEE ST	206 MAR		
SWAN LN	307	W CHICKASAW ST	206 MAR		
SYCAMORE AVE	112 FH	W CREEK ST	206 MAR		
T		W MAIN ST	206 MAR		
TABLER RD	304/307	W MILL ST	206 MAR		
TALIAFFERRO ST	110 LEON	W PONDEROSA PL	112		